

RoHS Compliance

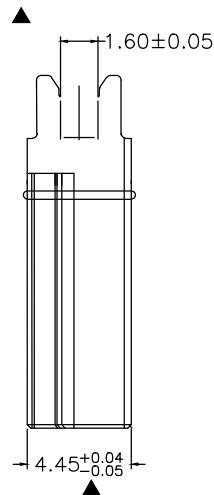
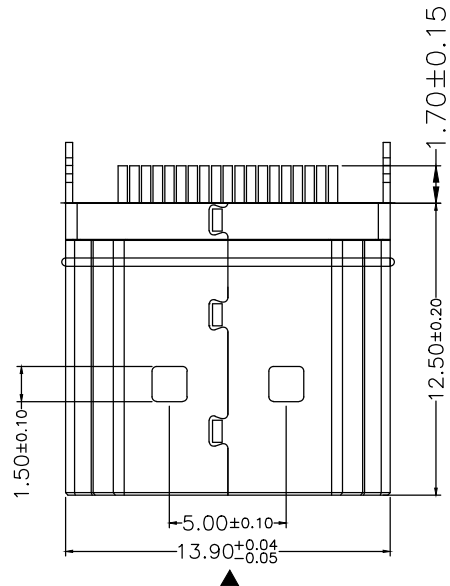
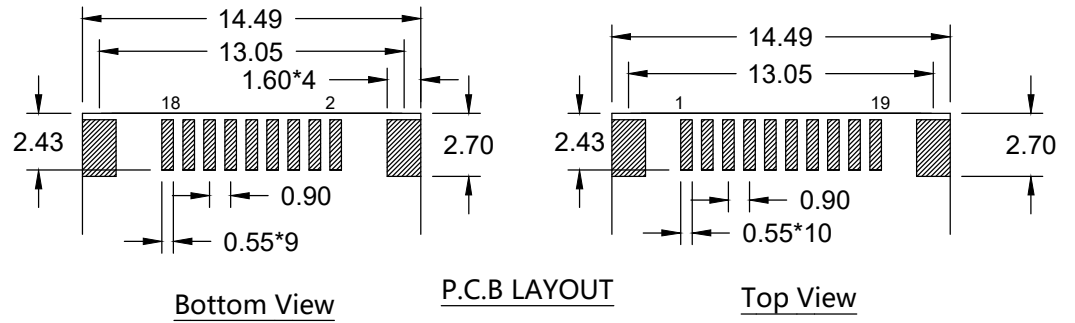
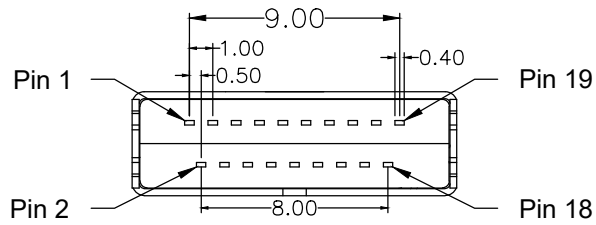

NOTE :

1. SPECIFICATION:

- 1-1. CURRENT RATING: 0.5 Amp Max.
- 1-2. VOLTAGE RATING: 40V ac(r.m.s) Max.
- 1-3. CONTACT RESISTANCE: 30m Ohms Max.mated
- 1-4. INSULATION RESISTANCE:100M Ohms Min.
- 1-5. DIELECTRIC WITHSTANDING VOLTAGE:
AC 500V Min. (for 1 minute)
- 1-6. OPERATION TEMPERATURE RANGE:-25°C~85°C

2. MECHANICAL :

- 2-1. INSERTION FORCE: 4.5kgf Max.
- 2-2. WITHDRAWAL FORCE: 1.0kgf Min. ;4.0kgf Max.
- 2-3. DURABILITY: 10,000 CYCLES AT 100±50 CYCLES
PER HOUR, CONTACT CHANCE FROM INITIAL VALUE:30m Ohms Max.
- 3. PIN FINISH : CONTACT AREA G/F PLATING

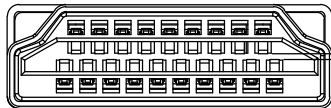

Note : PART NUMBER CODE:

XHDMIV-AMV19A-xx

① SHELL PLATED:

- 01 : Nickel, Ni.
- 02 : Gold, Au.

THIS DRAWING IS A CONTROLLED DOCUMENT. DO NOT SCALE DRAWING.	
DIMENSIONS: MM	TOLERANCES UNLESS OTHERWISE SPECIFIED:
	X ± 0.3 X.X ± 0.2 X.XX ± 0.1 X.XXX ± 0.05 ANGLES ± 5.0°
MATERIAL SEE NOTES	FINISH SEE NOTES
DWN T. Li	DATE OCT-17-2019
CHK D. Wang	OCT-17-2019
APVD R. Tsai	OCT-17-2019



TITLE
HDMI AM 19PINS, Clip Type

△	-	-	-
LTR	DESCRIPTION	DATE	APVD
REVISIONS			

SIZE A3	DRAWING NO XHDMI-AMV19A-01
WEIGHT - GRAMS Ref.	REV A
SHEET 1 / 1	