

RoHS Compliance

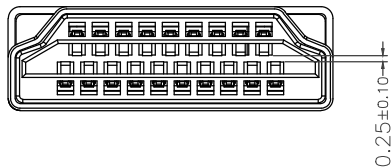
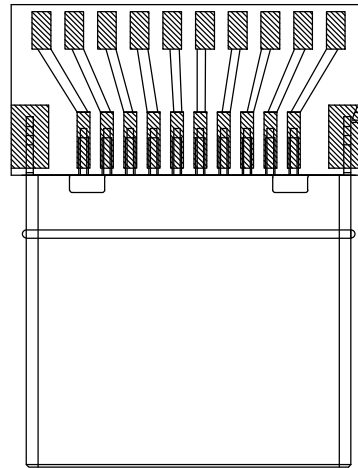
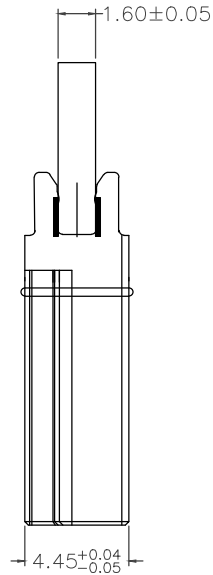
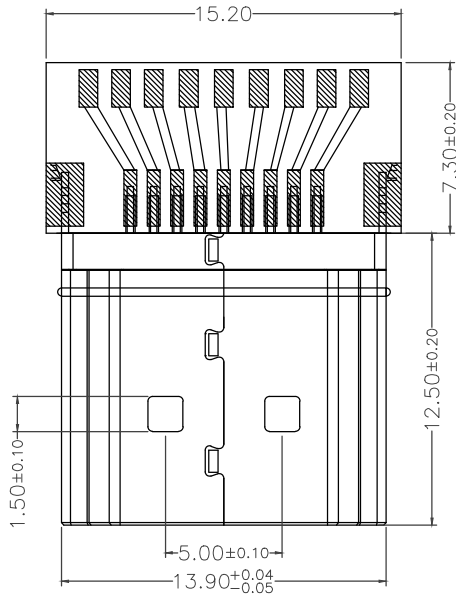
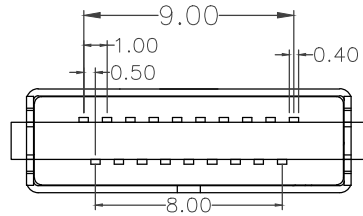

SPECIFICATION :

1. Electrical Characteristics :

- Contact Current Rating : 0.5 A
- Dielectric Withstanding Voltage : 300V AC
- Insulation Resistance :
 - a. Insertion 100MΩ Min. at 500V/DC.
 - b. Withdrawal 10MΩ Min. at 150V/DC.
- Contact Resistance : 30mΩ Max.
- Temperature Range : -20°C to +85°C.

2. Mechanical :

- Insertion Force : 44.1N Max.
- Withdrawal Force : 9.8N Min.;39.2N Max.
- Durability : 10,000 Cycles.

3. Material :

- Housing : Thermoplastics High Temp., LCP+Glass Fiber, Black, UL94V-0.
- Contact : Copper Alloy, T=0.20mm.
- Shell : SPCC, T=0.40mm.

4. Plating :

- Contact : Gold Plating on Contact Area(As Below Option), 100u"Min. Tin Plating ON Solder-Tails. 50u"Min, Nickel Under-Plating Over All.
- Shell : G/F Plating, Nickel Under-Plating Over All.

5. All Parts Meet RoHS Compliant.

P/N Option for Contact Area Plating :

XHDMI-AMPCGX-XX

CENTER CONTACT PLATING

01: GOLD FLASH

15: Au 15u"

30: Au 30u"

THIS DRAWING IS A CONTROLLED DOCUMENT.
DO NOT SCALE DRAWING.

DIMENSIONS:
MM

TOLERANCES UNLESS
OTHERWISE SPECIFIED:

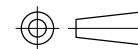

THIRD ANGLE PROJECTION

X	± 0.3
X.X	± 0.2
X.XX	± 0.1
X.XXX	± 0.05
ANGLES	± 5.0°

MATERIAL

FINISH

SEE NOTES

SEE NOTES

REVISIONS	DESCRIPTION	DATE	APVD
△ -			
LTR			

DWN T. LI

DATE OCT-17-2019

CHK D. Wang

OCT-17-2019

APVD R. Tsai

OCT-17-2019



TITLE

HDMI AM, W/PCB
T./L. 19.8mm, Shell G/F.

SIZE A3

DRAWING NO XHDMI-AMPCGX-XX

WEIGHT - GRAMS Ref. REV A SHEET 1/1