

RECOMMENDED  
PANEL CUTOUT DIMENSION

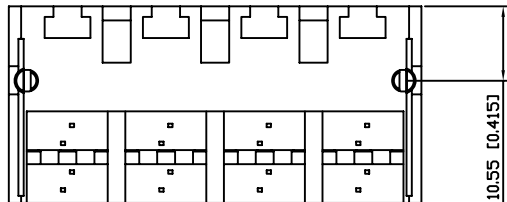

XRJD-U-24-6-2-0-1D1

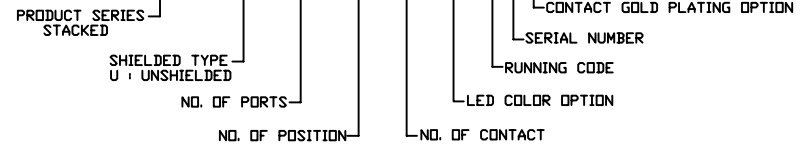

NOTES:

- MATERIALS:  
HOUSING: PBT, UL 94V-0, BLACK  
CONTACTS: T=0.35 mm PHOSPHOR BORNZE, 15u" GOLD PLATING OVER NICKEL.
- OPERATING TEMPERATURE: -40°C ~ +85°C
- JACK CAVITY CONFORMS TO FCC RULES AND REGULATIONS PART 68, SUBPART F
- UNSPECIFIED TOLERANCE: .XX ±0.25[0.010]  
.X ±0.30[0.012]

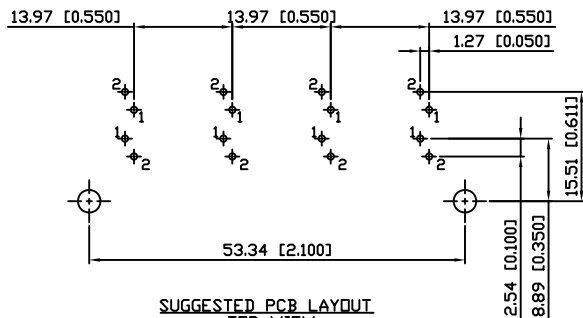

SUGGESTED PCB LAYOUT  
TOP VIEW  
DIMENSIONAL TOLERANCE: .XX ±0.08[0.003]

RoHS Compliant

X MULTIPLE		THE INFORMATION AGE	
XMULTIPLE ASIA 4F, No. 347, Yang Guang St., Neihu, Taipei, Taiwan 11475		XMULTIPLE USA 1420 Los Angeles Ave., Suite G, Simi Valley, CA 93065	
THIS DRAWING IS A CONTROLLED DOCUMENT.		G/NO: DWG NO: XRJD-U-24-6-2-0-1D1	
TITLE: Stacked RJ11 Connectors, W/D LED, 6P,2C, Unshielded, Thru Hole		DRAWN: TOM	
PART NO: XRJD-U-24-6-2-0-1D1		CHKD: JEFF	
		UNIT mm[inch]	SHEET 1 of 1
		REV 01	DATE: Dec.18,07