

1. MECHANICAL DIMENSIONS :

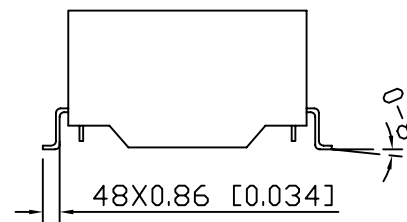
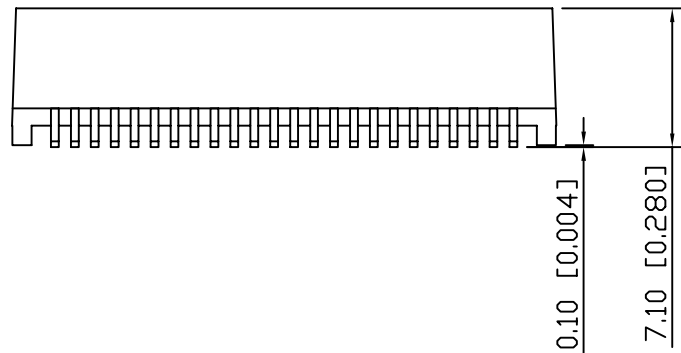
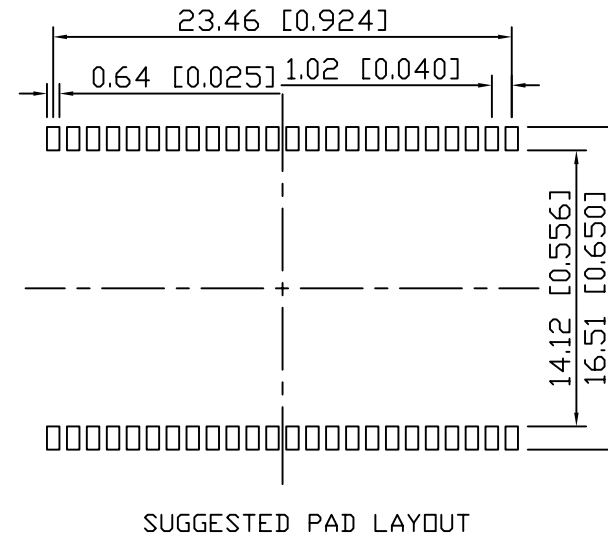
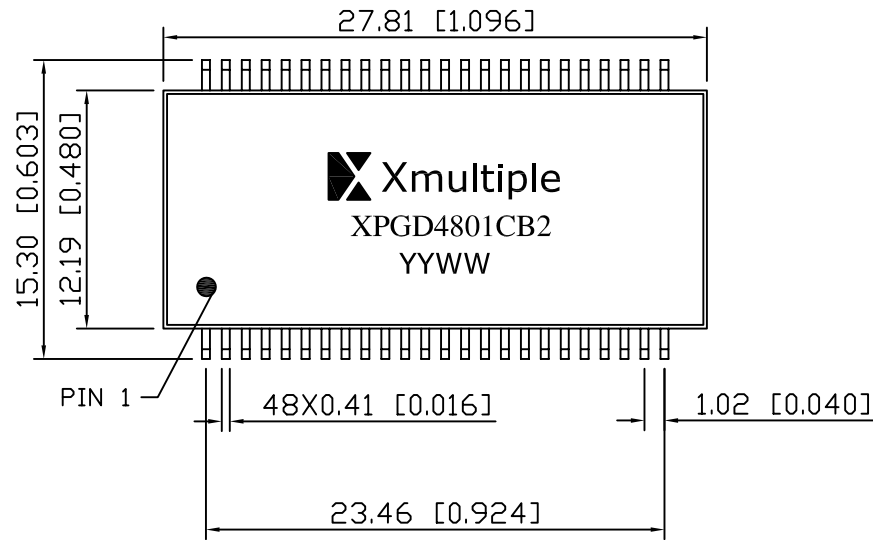

Dimensions: mm [Inches]
 Unless otherwise specified, all tolerances are ± 0.25 [0.010]

RoHS Compliant

X MULTIPLE		CONNECTING THE INFORMATION AGE	
XMULTIPLE ASIA 4F, No. 347, Yang Guang St., Neihu, Taipei, Taiwan 11475		XMULTIPLE USA 1420 Los Angeles Ave., Suite G, Simi Valley, CA 93065	
THIS DRAWING IS A CONTROLLED DOCUMENT.		G/NO:	
TITLE: 10/100/1000 Base-T Dual Port Surface Mount Magnetics For PoE		DWG NO: XTFZ-PGD4801CB2	
PART NO: XTFZ-PGD4801CB2		DRAWN: IVAN	
		CHKD: TARA	
		DATE: Jun.12,09	
UNIT mm [Inch]	SHEET 1 of 2	REV 01	

2. SCHEMATIC :

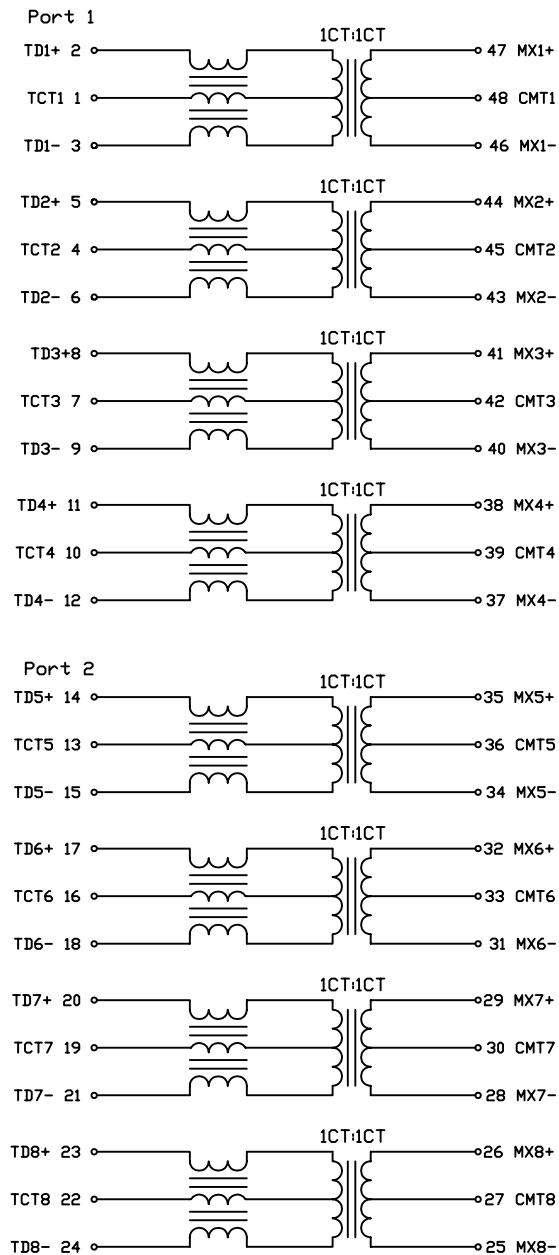

3. ELECTRICAL CHARACTERISTICS :

TEST NOTES:(25±5)

- TR:(100KHz,0.1V);
PINS:(2,3):(47,46);(5,6):(44,43)=1:1±3%
PINS:(8,9):(41,40);(11,12):(38,37)=1:1±3%
PINS:(14,15):(35,34);(17,18):(32,31)=1:1±3%
PINS:(20,21):(29,28);(23,24):(26,25)=1:1±3%
- LX:(100KHz,100mV,8mA, DC Bias)
PINS:(2,3),(5,6),(8,9),(11,12),(14,15),(17,18),(20,21),
(23,24)=350uH MIN
- DCR:
PINS:(2,3),(5,6),(8,9),(11,12),(14,15),(17,18),(20,21),
(23,24)=1.5 OHMS MAX
- HIPOT:
PINS: INPUT TO OUTPUT=1500VAC FOR 60 SECONDS
- INSERTION LOSS:
-1.1dB MAXIMUM AT 0.10MHz
-1.0dB MAXIMUM AT 100MHz
-2.0dB MAXIMUM AT 125MHz
- RETURN LOSS:
-18dB TYP AT 30MHz
-12dB TYP AT 60MHz
-12dB TYP AT 80MHz
-10dB TYP AT 100MHz
- CROSS TALK:
-43dB MIN AT 30MHz
-37dB MIN AT 60MHz
-33dB MIN AT 100MHz
- WORKING CURRENT FOR PoE HAS 350mA

RoHS Compliant

X MULTIPLE		CONNECTING THE INFORMATION AGE	
XMULTIPLE ASIA 4F, No. 347, Yang Guang St., Neihu, Taipei, Taiwan 11475		XMULTIPLE USA 1420 Los Angeles Ave., Suite G, Simi Valley, CA 93065	
THIS DRAWING IS A CONTROLLED DOCUMENT.		G/NO:	
TITLE: 10/100/1000 Base-T Dual Port Surface Mount Magnetics For PoE		DWG NO: XTFZ-PGD4801CB1	
PART NO: XTFZ-PGD4801CB2		DRAWN: IVAN	
		CHKD: TARA	
		DATE: Jun.12,09	
UNIT mm[Inch]	SHEET 2 of 2	REV 01	