

REV.	ECN NO.	DATE
A	Released	09/08/2011

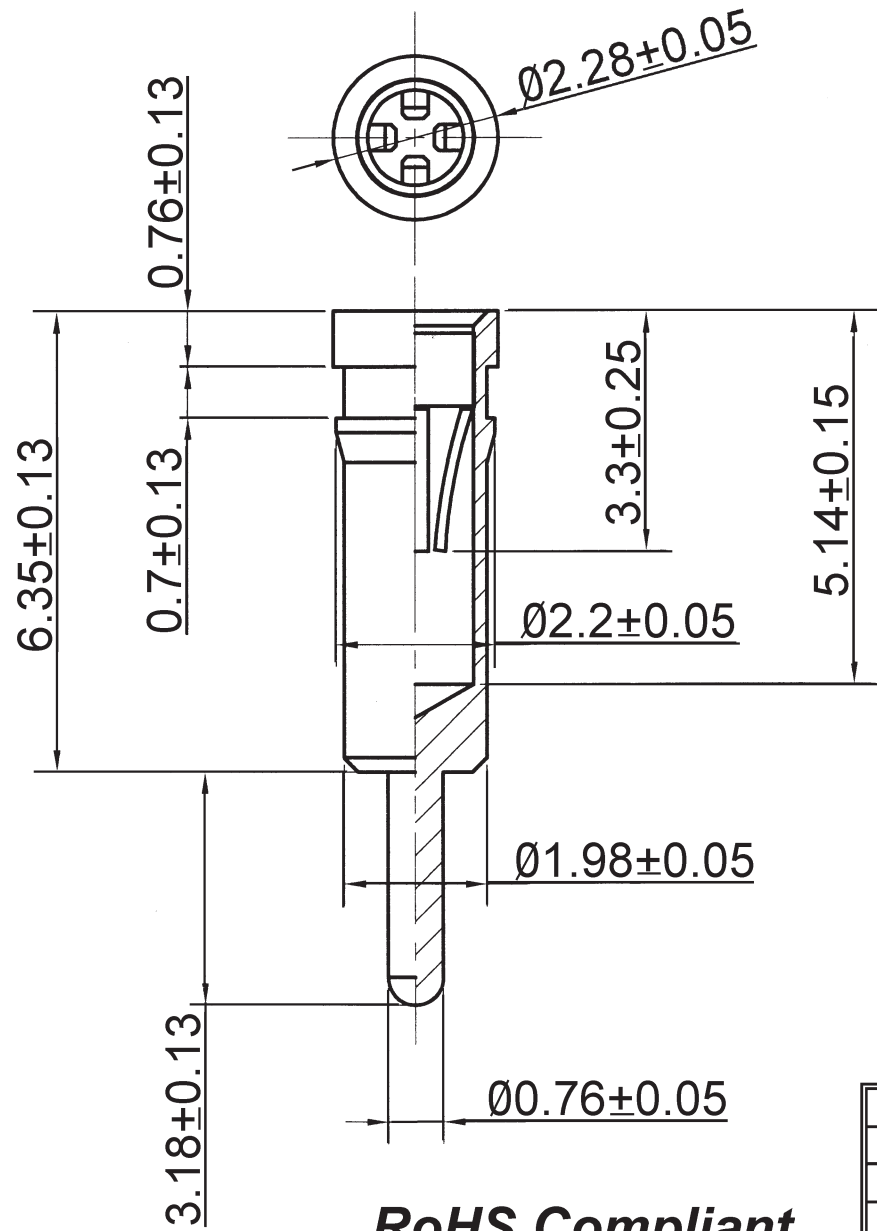

**Specifications:**

**Materials:**

- \* Pin (outer sleeve): Brass, machined
- \* Clip (4 finger contact): Beryllium Copper
- \* Plating:  
 Outer Sleeve: Tin plating  
 Contact: 30u" gold

How to Order:

XTB - ICS01 - M9.53 - 4 - x - x - SB1

- Contact plating:
  - G: gold flash
  - G15: 15u" gold
  - G30: 30u" gold
- Outer Sleeve plating:
  - T: Tin
  - G: Gold

**RoHS Compliant**

Scale		Drawn by	ANGLIA	<b>XMULTIPLE</b>	
Unit	mm	Checked by	Kevin		
Tolerance		Sheet	1 of 1	Name: Machined pin, 9.53mm 4 Finger Contacts	
.X	± 0.38	Projection		Part number	XTB-ICS01-M9.53-4-x-x-SB1
.XX	± 0.25			Drawing no.	ICS01-M9.53-4-x-x
.XXX	± 0.08				
ANG.	= 2°				