

REV.	ECN NO.	DATE
A	Released	09/08/2011
B	0908/11	09/08/2011

Specifications:

Materials:

- * Pin (outer sleeve): Brass, machined
- * Clip (4 finger contact): Beryllium Copper
- * Plating:
 Outer Sleeve: Tin plating
 Contact: 30u" gold

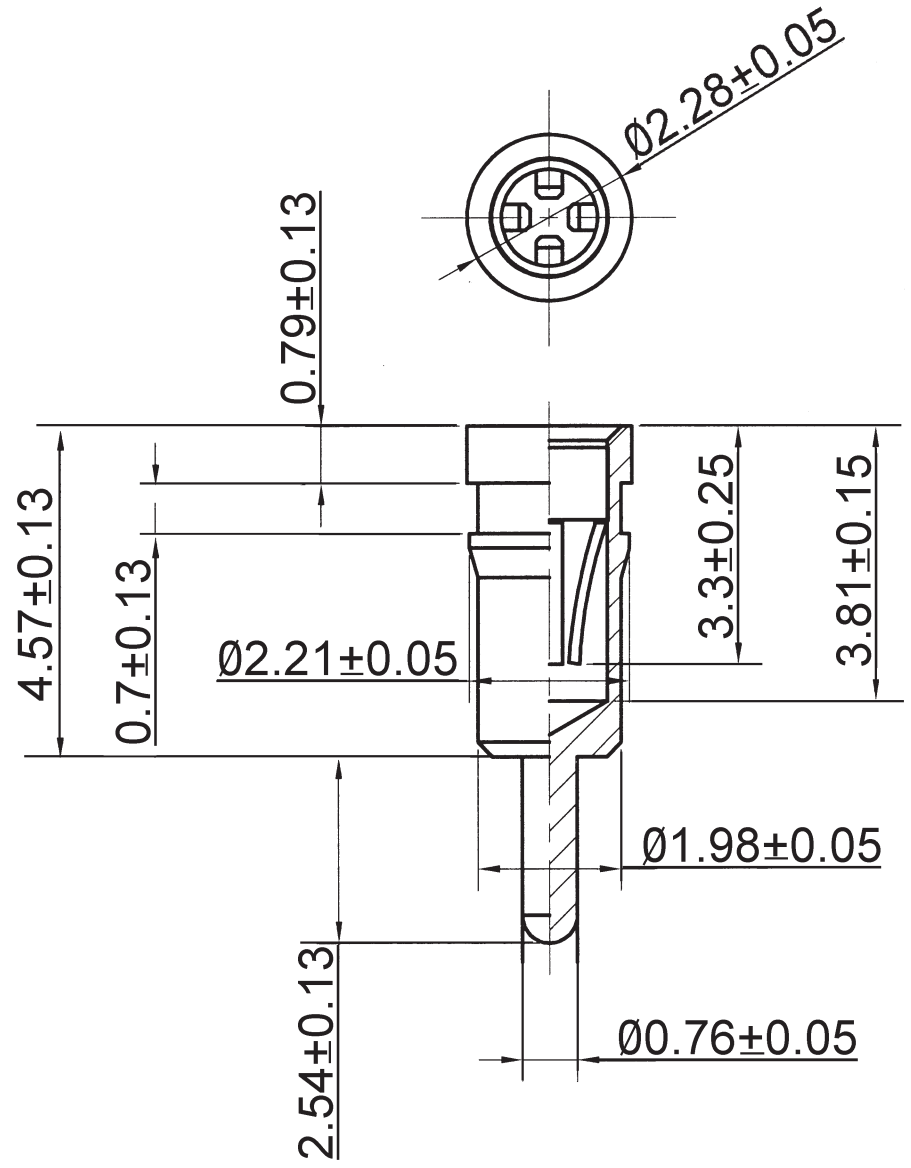

RoHS Compliant

How to Order:

XTB - ICS01 - M7.11 - 4 - x - x - SB1

Contact plating ——— Outer Sleeve plating
 G: gold flash T: Tin
 G15: 15u" gold G: Gold
 G30: 30u" gold

Scale		Drawn by	ANGLIA	XMULTIPLE
Unit	mm	Checked by	Kevin	
Tolerance		Sheet	1 of 1	
.X ± 0.38	Projection		Name: Machined pin, 7.11mm 4 Finger Contacts	
.XX ± 0.25			Part number	XTB-ICS01-M7.11-4-x-x-SB1
.XXX ± 0.08			Drawing no.	ICS01-M7.11-4-x-x
ANG. = 2°				