

RECOMMENDED P.C.B LAYOUT
TOP VIEW ±0.05

- NOTE:
- MATERIAL
INSULATOR: GLASS REINFORCED THERMOPLASTIC, UL94V-0, BLACK
CONTACTS: PHOSPHOR BRONZE
 - PLATING:
CONTACT AREA: 15u" GOLD PLATING
SOLDER TAILS: 3u" GOLD FLASH OVER 50u" NICKEL PLATE
 - ELECTRICAL:
VOLTAGE RATING: 120VAC MAX
CURRENT RATING: 0.5 AMP
CONTACT RESISTANCE: 35 MILLIOHMS MAX
INSULATION RESISTANCE: 500 MOHMS MIN
DIELECTRIC WITHSTANDING VOLTAGE: 300VAC/MINIMUM
 - ENVIRONMENTAL:
OPERATING TEMPERATURE: -55° TO +85°
 - PACKING: 500PCS/REEL, 2500PCS/CARTON
 - UNSPECIFIED TOLERANCE: .XXX ±0.10[0.004]
.XX ±0.20[0.008]
.X ±0.30[0.012]

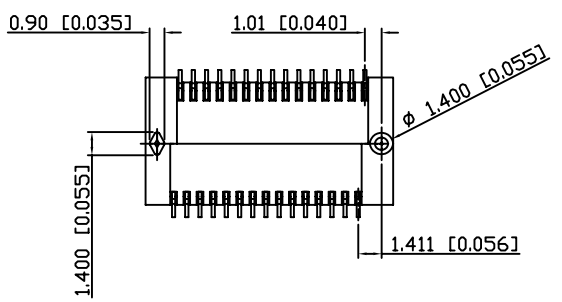
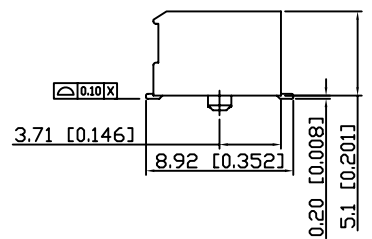
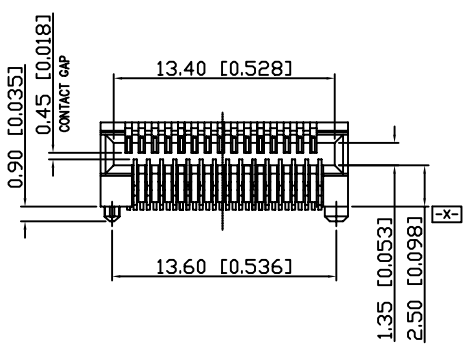

XXFP-N-SSM0-3001-MA

TYPE: N = CONNECTOR
S = STANDARD
SMT

SERIAL NUMBER: 0 = W/D LIGHT PIPE
NUMBER OF PIN: 0 = N/A

CUSTOMER CODE

RoHS Compliant

		CONNECTING THE INFORMATION AGE	
		G/NO:	
X MULTIPLE ASIA 4F, No. 347, Yang Guang St., Neihu, Taipei, Taiwan 11475		X MULTIPLE USA 1420 Los Angeles Ave., Suite G, Simi Valley, CA 93065	
THIS DRAWING IS A CONTROLLED DOCUMENT.			
TITLE: SMT CONNECTOR 0.80 MM CENTER 30 POSITIONS		DVG NO: XXFP-N-SSM0-3001-MA	
PART NO: XXFP-N-SSM0-3001-MA		DRAWN: IVAN	
		UNIT: mm [inch]	SHEET: 1 of 1
		REV: 01	DATE: Dec.15,08