

XSFP-K-SPFA-2201

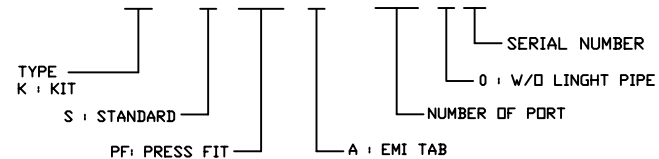

NOTE:

1. MATERIAL

HOUSING: HIGH TEMP, THERMOPLASTIC, UL94V-0, COLOR-BLACK.
 CONTACT: PHOS-BRONZE, 30 μ GOLD ON MATING AREA AND TIN ON PRESS-FIT
 TAIL OVER NICKEL UNDERPLATE

SHIELD: COPPER ALLOY, NICKEL PLATED.

INSERT: HIGH TEMP, THERMOPLASTIC, UL94V-0, COLOR-BLACK.

2. UNSPECIFIED TOLERANCE: .XX \pm 0.25[0.010]
 .X \pm 0.30[0.012]

RoHS Compliant

X MULTIPLE		CONNECTING THE INFORMATION AGE	
X MULTIPLE ASIA 4F, No. 347, Yang Guang St., Neihu, Taipei, Taiwan 11475		X MULTIPLE USA 1420 Los Angeles Ave., Suite G, Simi Valley, CA 93065	
THIS DRAWING IS A CONTROLLED DOCUMENT.		G/NO:	
TITLE: STACKED SFP 2#2 MEDIUM HEIGHT ASS'Y PRESS-FIT TAIL WITHOUT LIGHT PIPES		DWG NO: XSFP-K-SPFA-2201	
PART NO: XSFP-K-SPFA-2201		DRAWN: TOM	
		CHKD: TARA	
		DATE: Apr.15,09	
UNIT mm[inch]	SHEET 1 of 3	REV 01	

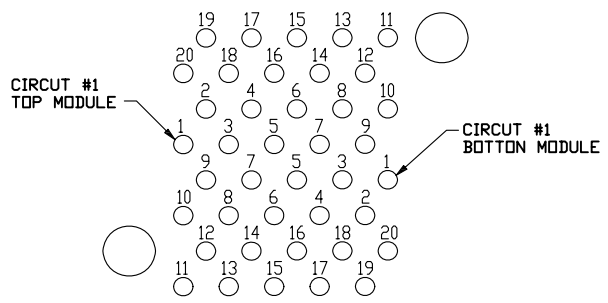

CONNECTOR PIN-OUT
COMPONENT SIDE OF BOARD

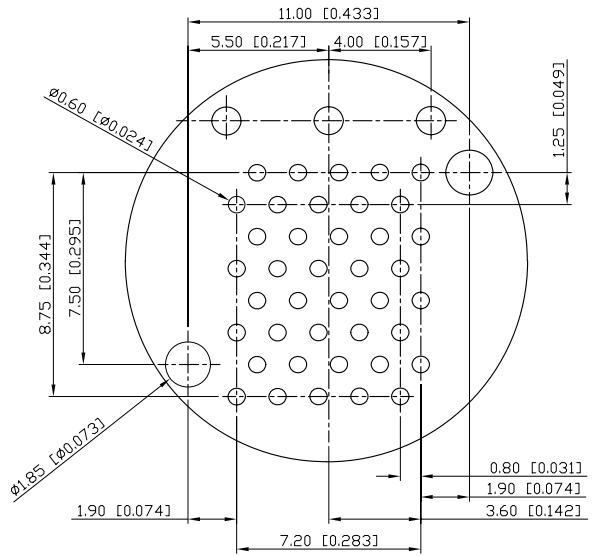

DETAIL A
SCALE 6:1

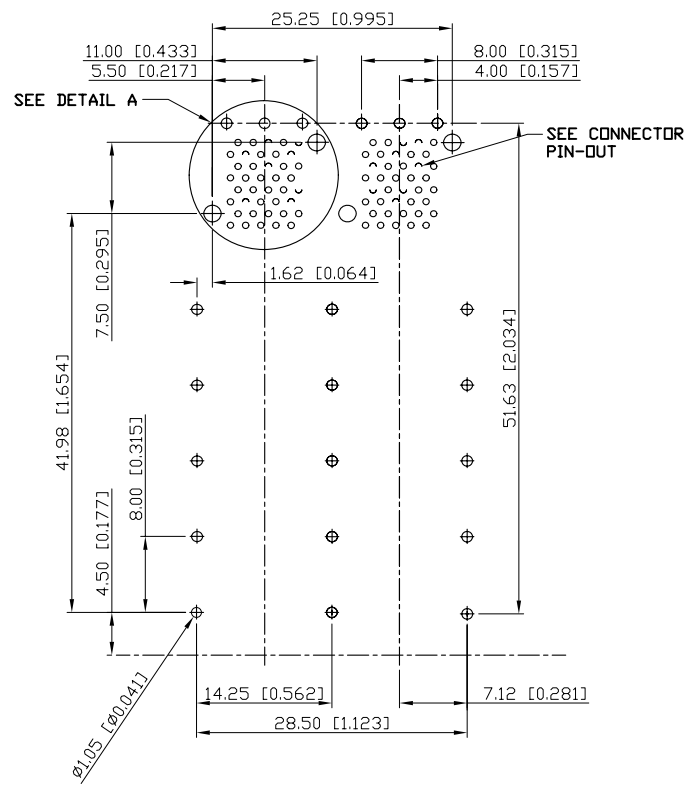
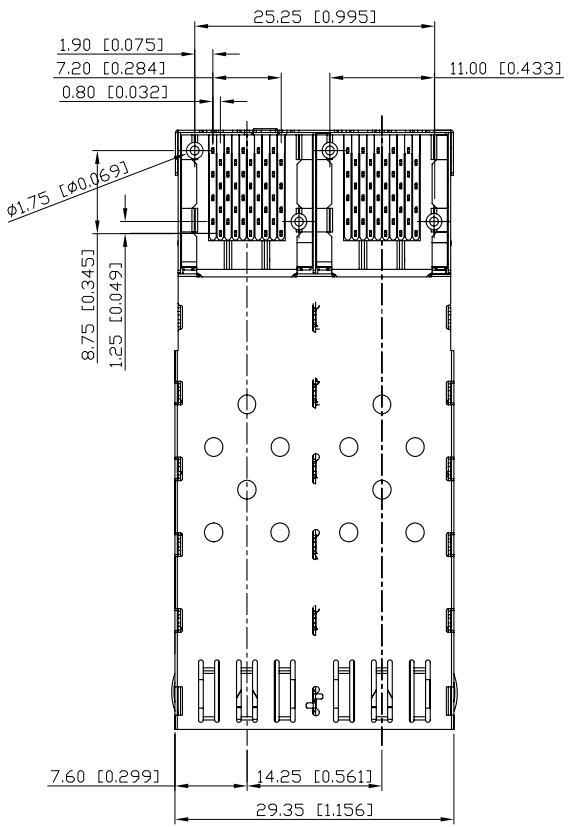

RoHS Compliant

X MULTIPLE		CONNECTING THE INFORMATION AGE	
XMULTIPLE ASIA 4F, No. 347, Yang Guang St., Neihu, Taipei, Taiwan 11475		XMULTIPLE USA 1420 Los Angeles Ave., Suite G, Simi Valley, CA 93065	
THIS DRAWING IS A CONTROLLED DOCUMENT.		G/NO: DWG NO: XSFP-K-SPFA-2201	
TITLE: STACKED SFP 2#2 MEDIUM HEIGHT ASS'Y PRESS-FIT TAIL WITHOUT LIGHT PIPES		DRAWN: TOM	
PART NO: XSFP-K-SPFA-2201		CHKD: TARA	
UNIT mm[inch]		SHEET 2 of 3	
DATE: Apr.15,09		REV 01	

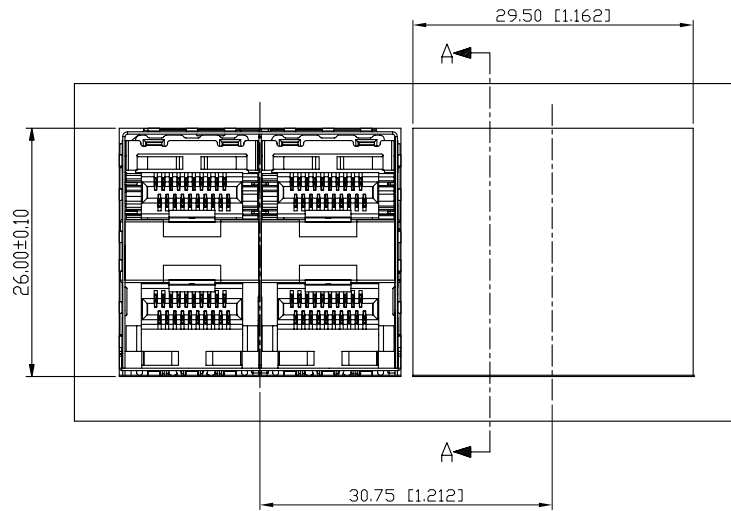

BEZEL CUT-OUT CENTER SPACING DETAIL
BEZEL THICKNESS: 0.8-2.6

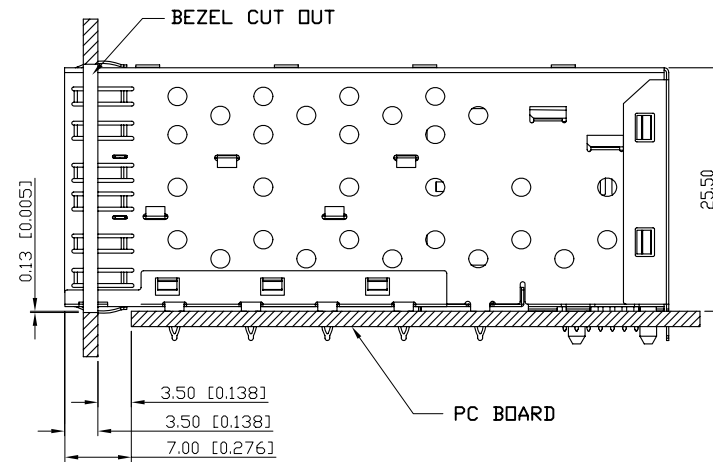

RoHS Compliant

		CONNECTING THE INFORMATION AGE	
XMULTIPLE ASIA 4F, No. 347, Yang Guang St., Neihu, Taipei, Taiwan 11475		XMULTIPLE USA 1420 Los Angeles Ave., Suite G, Simi Valley, CA 93065	
THIS DRAWING IS A CONTROLLED DOCUMENT.			
TITLE:		DVG NO:	
STACKED SFP 2#2 MEDIUM HEIGHT ASS'Y PRESS-FIT TAIL WITHOUT LIGHT PIPES		XSFP-K-SPFA-2201	
PART NO:		DRAWN:	
XSFP-K-SPFA-2201		TOM	
		CHKD:	
UNIT mm[inch]		TARA	
SHEET 3 of 3		DATE:	
REV 01		Apr.15,09	