

1. ASSEMBLY :

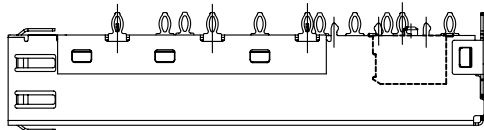

XSFP-K-SPFA-0201

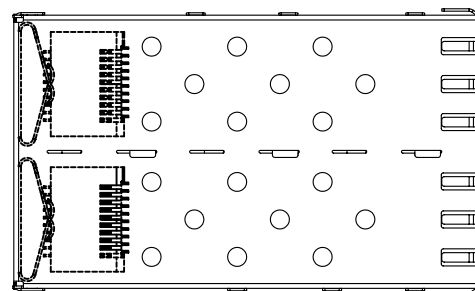
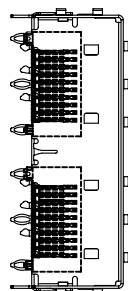
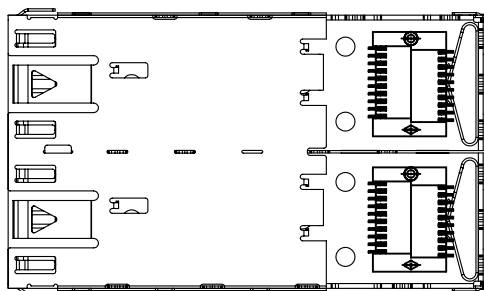
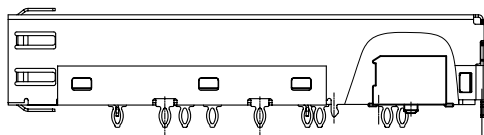
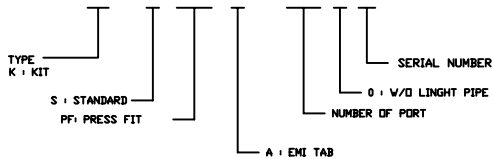

RoHS Compliant

		CONNECTING THE INFORMATION AGE		
				XMULTIPLE ASIA 4F, No. 347, Yang Guang St., Neihu, Taipei, Taiwan 11475
THIS DRAWING IS A CONTROLLED DOCUMENT.				DVG NO: XSFP-K-SPFA-0201
TITLE: SFP KIT: CAGE 1x2 PORT PRESS FIT TYPE +SMT CONNECTOR 0.80 MM 20 POSITIONS		DRAWN: IVAN		
PART NO: XSFP-K-SPFA-0201		CHKD: TARA		
	UNIT mm[inch]	SHEET 1 of 4	REV 01	
		DATE: Feb.05,09		

2. PCB LAYOUT :

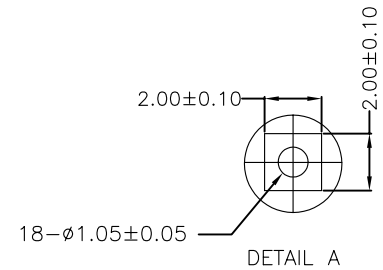
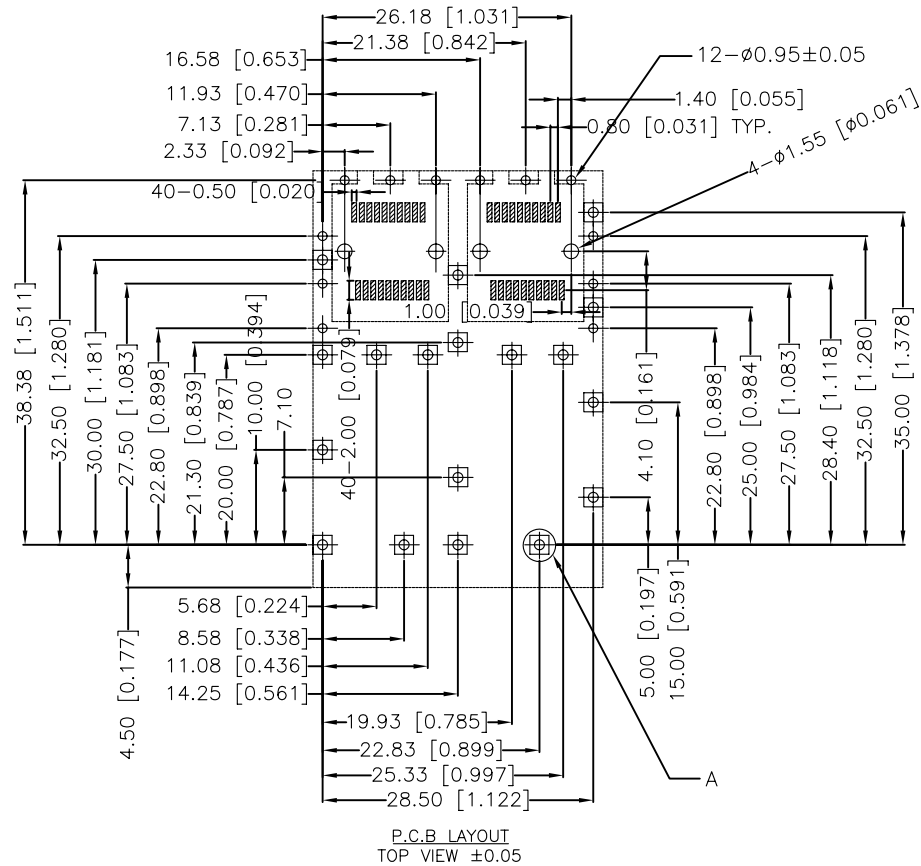

RoHS Compliant

		CONNECTING THE INFORMATION AGE		
				XMULTIPLE ASIA 4F, No. 347, Yang Guang St., Neihu, Taipei, Taiwan 11475
THIS DRAWING IS A CONTROLLED DOCUMENT.				DWG NO: XSFP-K-SPFA-0201
TITLE:		SFP KIT: CAGE 1x2 PORT PRESS FIT TYPE +SMT CONNECTOR 0.80 MM 20 POSITIONS		DRAWN: IVAN
PART NO:		XSFP-K-SPFA-0201		CHKD: TARA
		UNIT mm[inch]	SHEET 2 of 4	REV 01
		DATE: Feb.05,09		

3. CONNECTOR :

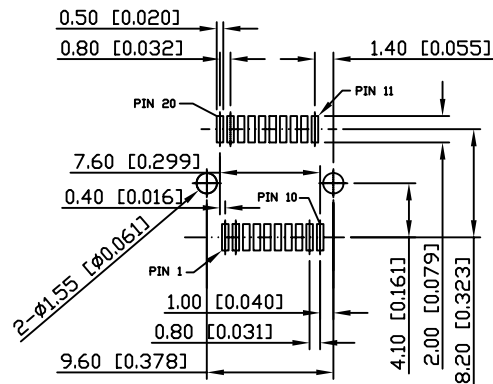
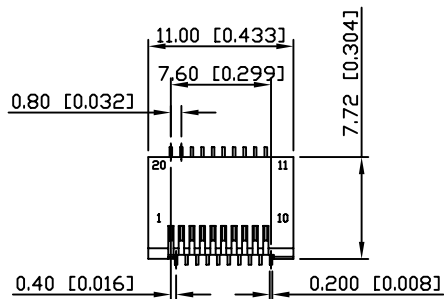

RECOMMENDED P.C.B LAYOUT
TOP VIEW ±0.05

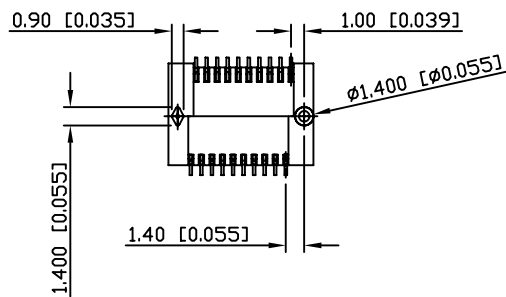
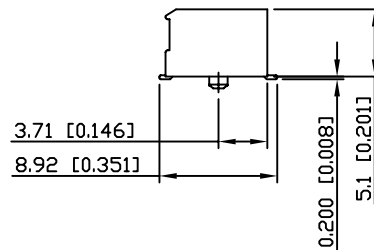
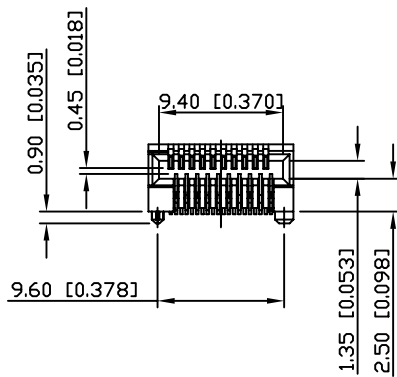

NOTE:

- MATERIAL
INSULATOR: GLASS REINFORCED THERMOPLASTIC,
UL94V-0, BLACK
CONTACTS: PHOSPHOR BRONZE
- PLATING:
CONTACT AREA: 15u" GOLD PLATING
SOLDER TAILS: 3u" GOLD FLASH OVER 50u" NICKEL PLATE
- ELECTRICAL:
VOLTAGE RATING: 120VAC MAX
CURRENT RATING: 0.5 AMP
CONTACT RESISTANCE: 35 MILLIOHMS MAX
INSULATION RESISTANCE: 500 MOHMS MIN
DIELECTRIC WITHSTANDING VOLTAGE: 300VAC/MINIMUM
- ENVIRONMENTAL:
OPERATING TEMPERATURE: -55° TO +85°
- PACKING: 500PCS/REEL, 2500PCS/CARTON
- UNSPECIFIED TOLERANCE: .XXX ±0.10[0.004]
.XX ±0.20[0.008]
.X ±0.30[0.012]

RoHS Compliant

		CONNECTING THE INFORMATION AGE	
X MULTIPLE ASIA 4F, No. 347, Yang Guang St., Neihu, Taipei, Taiwan 11475		X MULTIPLE USA 1420 Los Angeles Ave., Suite G, Simi Valley, CA 93065	
THIS DRAWING IS A CONTROLLED DOCUMENT.			
TITLE: SFP KIT: CAGE 1x2 PORT PRESS FIT TYPE +SMT CONNECTOR 0.80 MM 20 POSITIONS		DWG NO: XSFP-K-SPFA-0201	
PART NO: XSFP-K-SPFA-0201		DRAWN: IVAN	
		UNIT: mm[inch]	SHEET: 3 of 4
DATE: Feb.05,09		REV: 01	CHKD: TARA

4. CAGE :

NOTE:

- 1.MATERIAL: COPPER ALLOY,NICKEL PLATED
- 2.PLATING: 100u" Ni FOR ALL
- 3.PACKING: 45PCS/Tray ; 450PCS/Carton

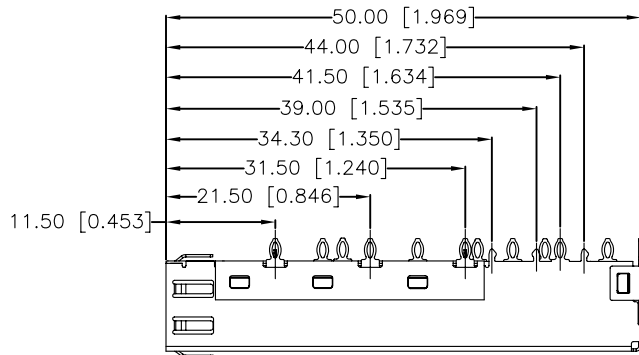
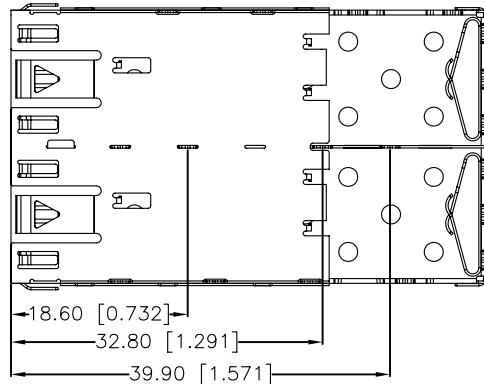
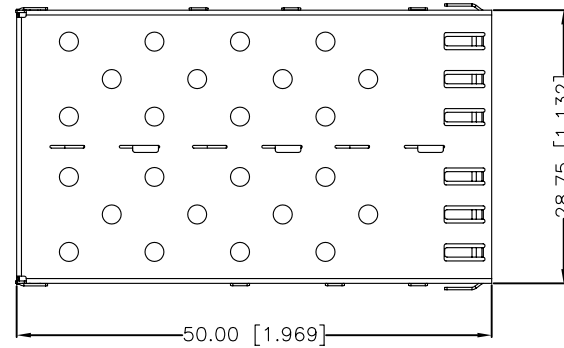
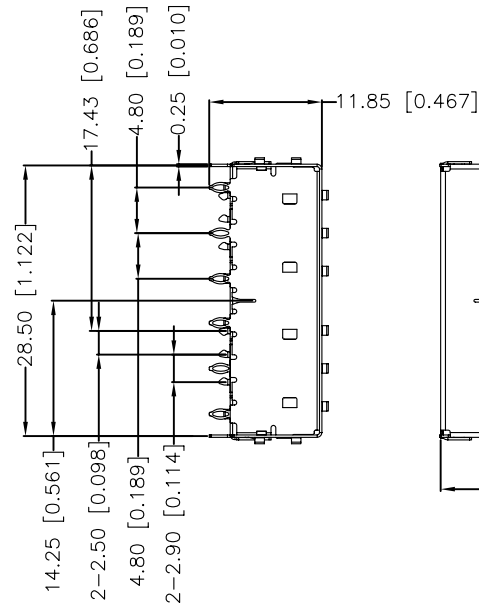
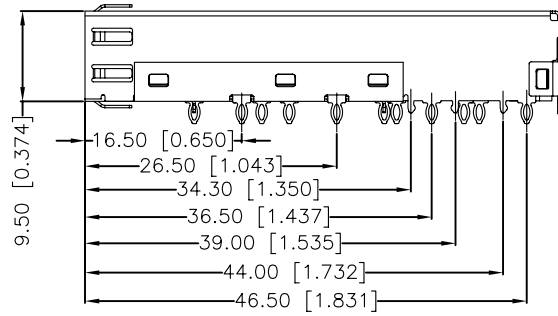

RoHS Compliant

		CONNECTING THE INFORMATION AGE	
XMULTIPLE ASIA 4F, No. 347, Yang Guang St., Neihu, Taipei, Taiwan 11475		XMULTIPLE USA 1420 Los Angeles Ave., Suite G, Simi Valley, CA 93065	
THIS DRAWING IS A CONTROLLED DOCUMENT.			
TITLE: SFP KIT, CAGE 1x2 PORT PRESS FIT TYPE +SMT CONNECTOR 0.80 MM 20 POSITIONS		DWG NO: XSFP-K-SPFA-0201	
PART NO: XSFP-K-SPFA-0201		DRAWN: IVAN	
		CHKD: TARA	
UNIT: mm[inch]		SHEET: 4 of 4	
REV: 01		DATE: Feb.05,09	