

1. ASSEMBLY :

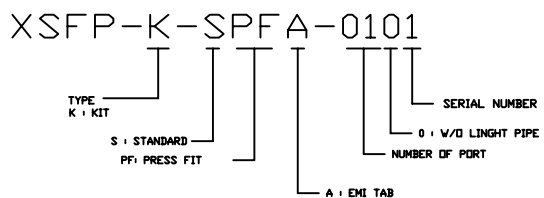
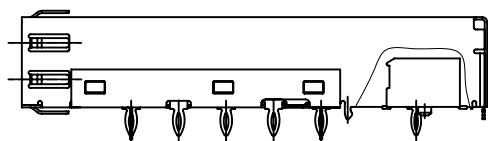
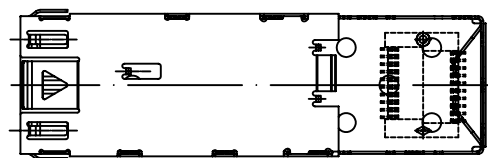
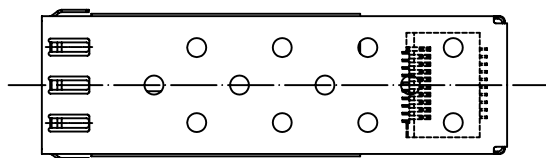
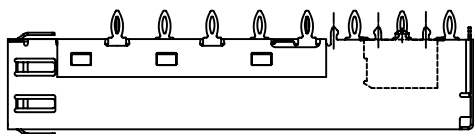

RoHS Compliant

		CONNECTING THE INFORMATION AGE		
				XMULTIPLE ASIA 4F, No. 347, Yang Guang St., Neihu, Taipei, Taiwan 11475
THIS DRAWING IS A CONTROLLED DOCUMENT.				DWG NO: XSFP-K-SPFA-0101
TITLE: SFP KIT; CAGE 1 PORT PRESS FIT TYPE +SMT CONNECTOR 0.80 MM CENTER 20 POSITIONS				DRAWN: IVAN
PART NO: XSFP-K-SPFA-0101				CHKD: TARA
	UNIT mm[inch]	SHEET 1 of 4	REV 01	DATE: Feb.16,09

3. CONNECTOR :

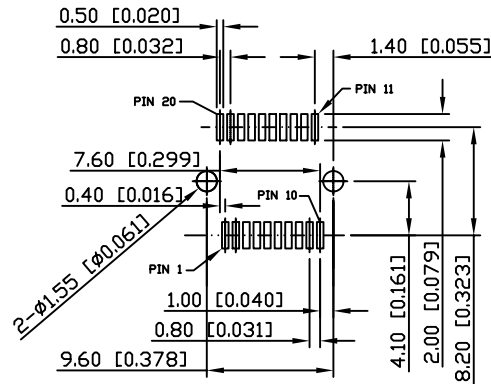
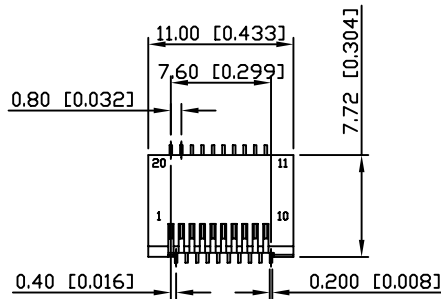

RECOMMENDED P.C.B LAYOUT
TOP VIEW ±0.05

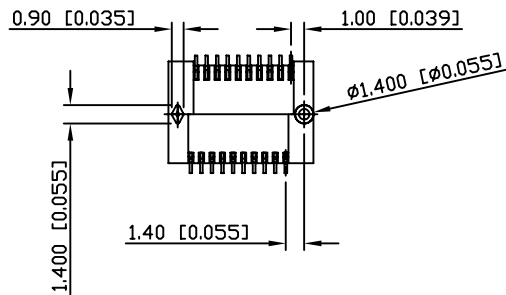
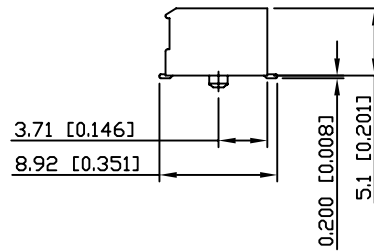
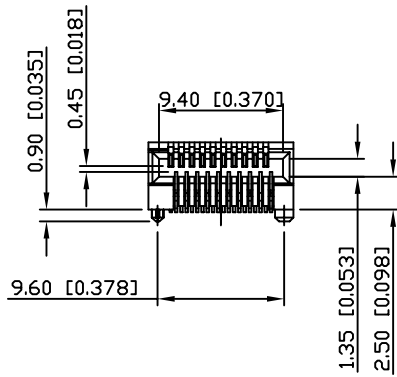

NOTE:

- MATERIAL
INSULATOR: GLASS REINFORCED THERMOPLASTIC,
UL94V-0, BLACK
CONTACTS: PHOSPHOR BRONZE
- PLATING:
CONTACT AREA: 15u" GOLD PLATING
SOLDER TAILS: 3u" GOLD FLASH OVER 50u" NICKEL PLATE
- ELECTRICAL:
VOLTAGE RATING: 120VAC MAX
CURRENT RATING: 0.5 AMP
CONTACT RESISTANCE: 35 MILLIOHMS MAX
INSULATION RESISTANCE: 500 MOHMS MIN
DIELECTRIC WITHSTANDING VOLTAGE: 300VAC/MINIMUM
- ENVIRONMENTAL:
OPERATING TEMPERATURE: -55° TO +85°
- PACKING: 500PCS/REEL, 2500PCS/CARTON
- UNSPECIFIED TOLERANCE: .XXX ±0.10[0.004]
.XX ±0.20[0.008]
.X ±0.30[0.012]

RoHS Compliant

		CONNECTING THE INFORMATION AGE	
X MULTIPLE ASIA 4F, No. 347, Yang Guang St., Neihu, Taipei, Taiwan 11475		X MULTIPLE USA 1420 Los Angeles Ave., Suite G, Simi Valley, CA 93065	
THIS DRAWING IS A CONTROLLED DOCUMENT.			
TITLE: SFP KIT: CAGE 1 PORT PRESS FIT TYPE +SMT CONNECTOR 0.80 MM CENTER 20 POSITIONS		DVG NO: XSFP-K-SPFA-0101	
PART NO: XSFP-K-SPFA-0101		DRAWN: IVAN	
		UNIT: mm [inch]	SHEET: 3 of 4
		REV: 01	CHKD: TARA
		DATE: Feb.16,09	

4. CAGE :

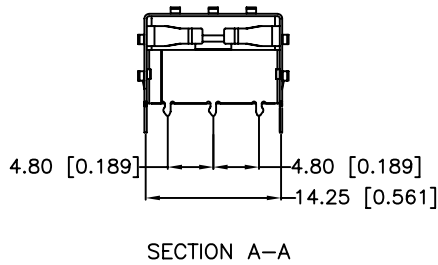
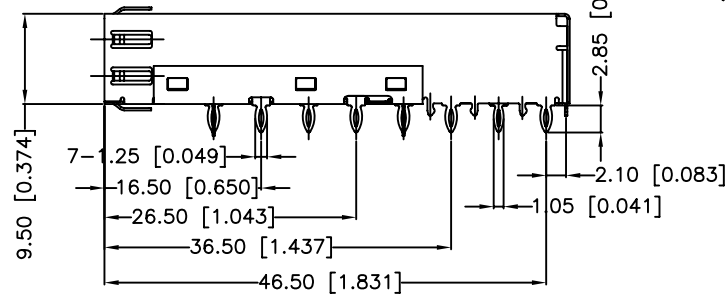
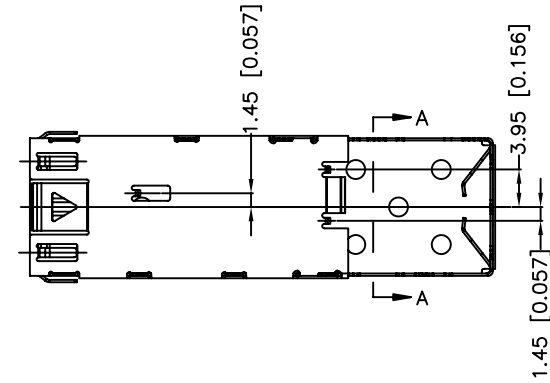
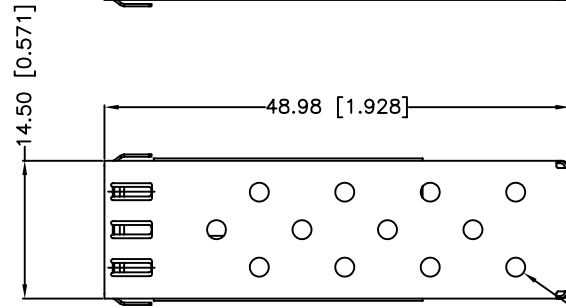
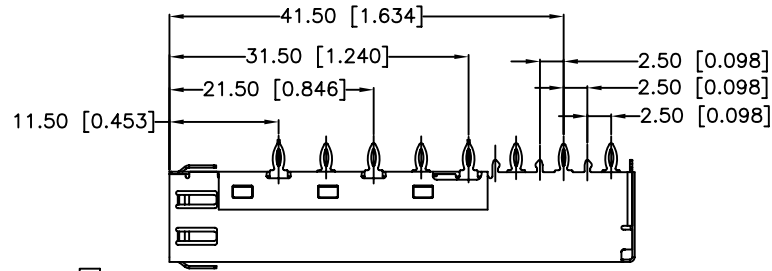

- NOTE:
 1.MATERIAL: COPPER ALLOY,NICKEL PLATED
 2.PLATING: 100u" Ni FOR ALL
 3.PACKING: 50PCS/Tray ;500PCS/Carton

RoHS Compliant

X MULTIPLE		CONNECTING THE INFORMATION AGE	
XMULTIPLE ASIA 4F, No. 347, Yang Guang St., Neihu, Taipei, Taiwan 11475		XMULTIPLE USA 1420 Los Angeles Ave., Suite G, Simi Valley, CA 93065	
G/NO:		DVG NO:	
THIS DRAWING IS A CONTROLLED DOCUMENT.		XSFP-K-SPFA-0101	
TITLE: SFP KIT: CAGE 1 PORT PRESS FIT TYPE +SMT CONNECTOR 0.80 MM CENTER 20 POSITIONS		DRAWN: IVAN	
PART NO: XSFP-K-SPFA-0101		CHKD: TARA	
		UNIT	SHEET
		mm[inch]	4 of 4
		REV	DATE:
		01	Feb.16,09