

NOTES:

- MATERIALS:  
HOUSING: HIGH TEMP. THERMOPLASTIC, PBT, UL 94V-0, BLACK.  
CONTACTS: T=0.35 mm PHOSPHOR BORNZE, 50u" NICKEL UNDERPLATE ON ALL AREA, 100u" TIN ON TERMINATION END, 15u" GOLD ON CONTACT AREA.  
SHIELD: T=0.25 mm COPPER ZINC ALLOY WITH NICKEL.
- OPERATING TEMPERATURE: -40°C ~ +85°C
- JACK CAVITY CONFORMS TO FCC RULES AND REGULATIONS PART 68, SUBPART F
- UNSPECIFIED TOLERANCE: .XX ±0.25[0.010]  
.X ±0.30[0.012]

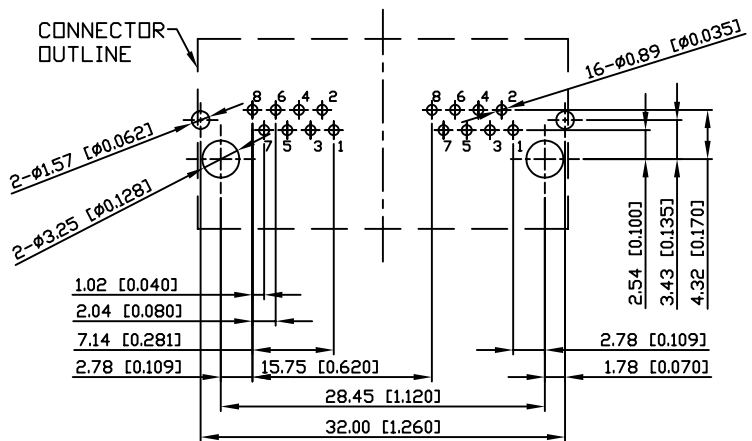

SUGGESTED PCB LAYOUT

(TOP VIEW)

△E DIMENSIONAL TOLERANCE: .XX ±0.08[0.003]

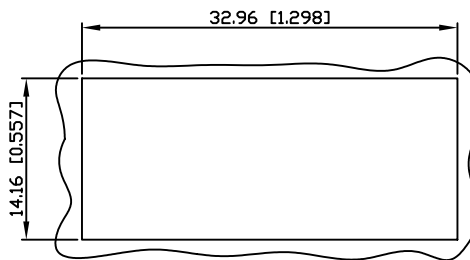

△E RECOMMENDED  
PANEL CUTOUT DIMENSION

XRJM-S-02-8-8-0

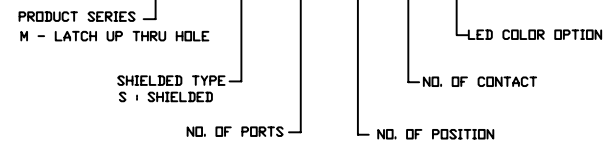

RoHS Compliant

X MULTIPLE

CONNECTING  
THE INFORMATION  
AGE

XMULTIPLE ASIA  
4F, No. 347, Yang Guang St.,  
Neihu, Taipei, Taiwan 11475

XMULTIPLE USA  
1420 Los Angeles Ave., Suite G,  
Simi Valley, CA 93065

G/NO:

THIS DRAWING IS A CONTROLLED DOCUMENT.

DWG NO:  
XRJM-S-02-8-8-0

TITLE:  
RJ45 Connectors, W/D LED, 8P,8C, Shielded, Thru-Hole

DRAWN:  
RUNES

PART NO:  
XRJM-S-02-8-8-0

CHKD:  
JEFF

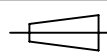

UNIT

SHEET

REV

mm[inch]

1 of 1

E

DATE:  
Jan.23,07