

FRONT VIEW

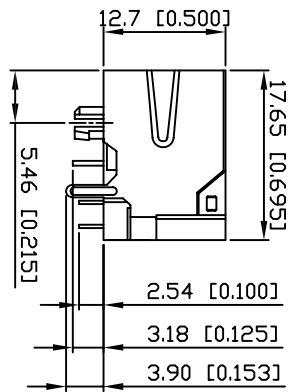

SIDE VIEW

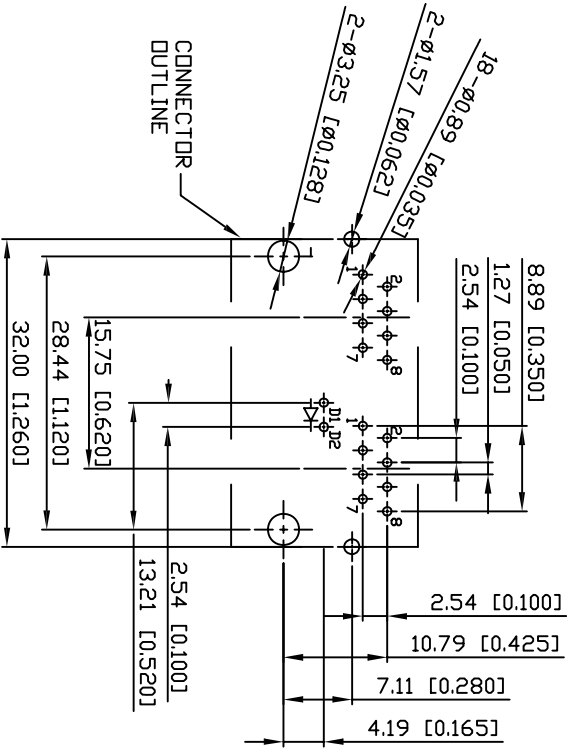
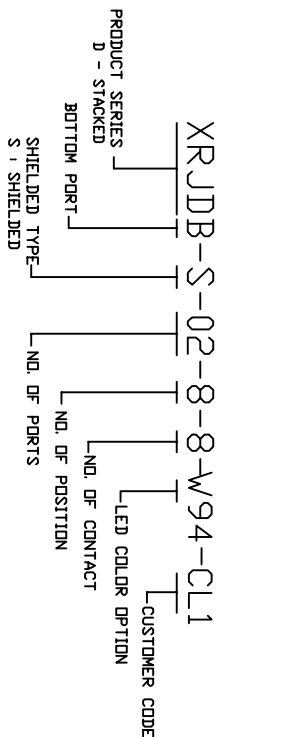

SUGGESTED PCB LAYOUT
TOP VIEW

DIMENSIONAL TOLERANCE: .XX ±0.08(0.003)

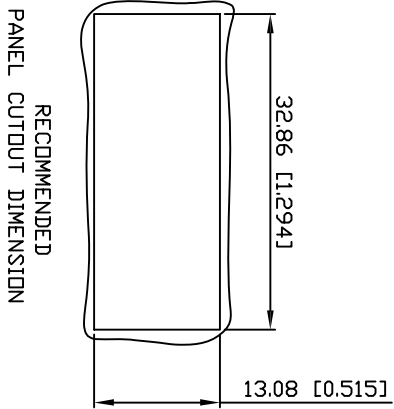

RECOMMENDED
PANEL CUTOUT DIMENSION

- NOTES:
1. MATERIALS:
HOUSING: HIGH TEMP. THERMOPLASTIC, PBT, UL 94V-0, BLACK
CONTACTS: T=0.35 mm PHOSPHOR BORNEZE, 50µr NICKEL UNDERPLATE
ON ALL AREA, 100µr TIN ON TERMINATION END,
15µr GOLD ON CONTACT AREA.
 2. OPERATING TEMPERATURE: -40°C ~ +85°C
 3. JACK CAVITY CONFORMS TO FCC RULES AND REGULATIONS PART 68,
SUBPART F
 4. UNSPECIFIED TOLERANCE: .XX ±0.25(0.010)
X ±0.30(0.012)

				THE INFORMATION AGE			
				1420 Los Angeles Ave., Suite G, Sim Valley, CA 93065			
THIS DRAWING IS A CONTROLLED DOCUMENT.							
TITLE:		Stacked RJ45 Connectors Bottom port, W/LED, BP/BC, Shielded, Thru Hole					
PART NO.		XRJDB-S-02-8-8-W94-CL1					
UNIT		SHEET		REV		DATE	
mmlhchl		1 of 1		01		2011/3/01	
DRAWN:				CHKD:			
Bob				IP1S			