

SUGGESTED PCB LAYOUT
TOP VIEW
DIMENSIONAL TOLERANCE: .XX ±0.08[0.003]

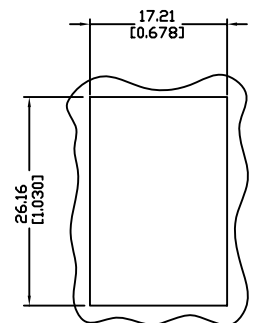

RECOMMENDED
PANEL CUTOUT DIMENSION

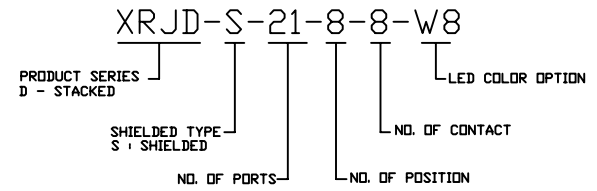

NOTES:

- MATERIALS:**
HOUSING: HIGH TEMP. THERMOPLASTIC, PBT, UL 94V-0, BLACK
CONTACTS: T=0.35 mm PHOSPHOR BORNZE, 50u" NICKEL UNDERPLATE ON ALL AREA, 100u" TIN ON TERMINATION END, 15u" GOLD ON CONTACT AREA.
SHIELD: T=0.25 mm COPPER ZINC ALLOY PLATED WITH NICKEL
- OPERATING TEMPERATURE:** -40°C ~ +85°C
- JACK CAVITY CONFORMS TO FCC RULES AND REGULATIONS PART 68, SUBPART F**
- UNSPECIFIED TOLERANCE:** .XX ±0.25[0.010]
.X ±0.30[0.012]

RoHS Compliant

X MULTIPLE			CONNECTING THE INFORMATION AGE	
XMULTIPLE ASIA 4F, No. 347, Yang Guang St., Neihu, Taipei, Taiwan 11475		XMULTIPLE USA 1420 Los Angeles Ave., Suite G, Simi Valley, CA 93065		G/ND
THIS DRAWING IS A CONTROLLED DOCUMENT.				DWG NO: XRJD-S-21-8-8-W8
TITLE: Stacked RJ45 Connectors, w/LED, 8P,8C, Shielded, Thru Hole, 2 Piece Structure.				DRAWN: TOM
PART NO: XRJD-S-21-8-8-W8				CHKD: JEFF
		UNIT mm[Inch]	SHEET 1 of 1	REV A
				DATE: Feb.04,08