

FRONT VIEW

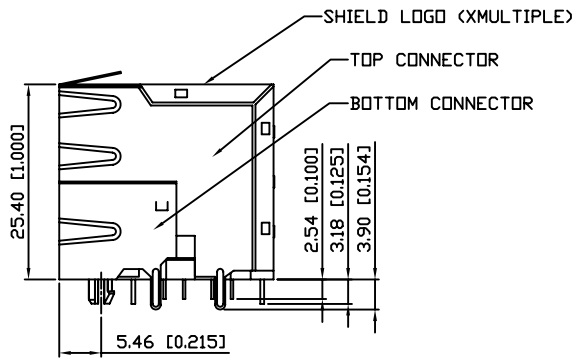

SIDE VIEW

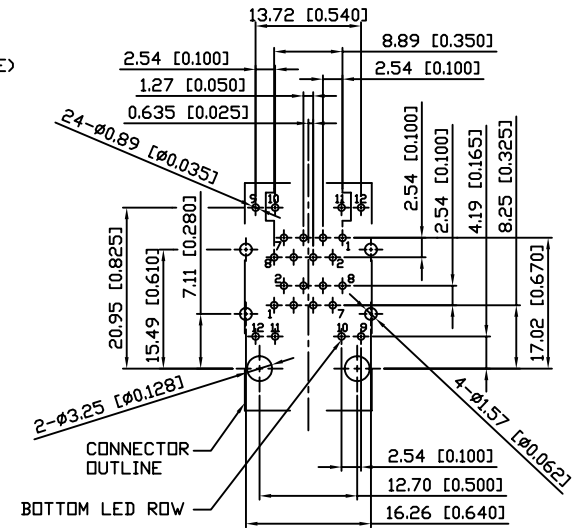

SUGGESTED PCB LAYOUT  
TOP VIEW  
DIMENSIONAL TOLERANCE: .XX ±0.08[0.003]

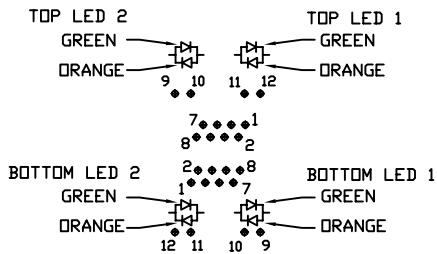

LED SCHEMATIC

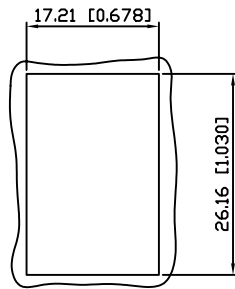

RECOMMENDED  
PANEL CUTOUT DIMENSION

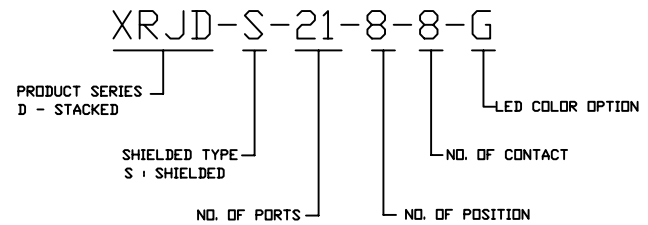

NOTES:

- MATERIALS:  
HOUSING: HIGH TEMP, THERMOPLASTIC, PBT, UL 94V-0, BLACK  
CONTACTS: T=0.35 mm PHOSPHOR BORNEZE, 50u' NICKEL UNDERPLATE  
ON ALL AREA, 100u' TIN ON TERMINATION END,  
15u' GOLD ON CONTACT AREA.  
SHIELD: T=0.25 mm COPPER ZINC ALLOY PLATED WITH NICKEL
- OPERATING TEMPERATURE : -45°C~80°C
- JACK CAVITY CONFORMS TO FCC RULES AND REGULATIONS PART 68, SUBPART F
- UNSPECIFIED TOLERANCE: .XX ±0.25[0.010]  
.X ±0.30[0.012]

RoHS Compliant

<b>XMULTIPLE</b>		THE INFORMATION AGE	
<small>XMULTIPLE ASIA 4F, No. 347, Yang Guang St., Neihu, Taipei, Taiwan 11475</small>		<small>XMULTIPLE USA 1420 Los Angeles Ave., Suite G, Simi Valley, CA 93065</small>	
<b>THIS DRAWING IS A CONTROLLED DOCUMENT.</b>		<small>G/NO: DWG NO: DRAWN: IVAN CHKD: TARA DATE: Mar, 24, 09</small>	
<small>TITLE: Stacked RJ45 Connectors, w/LED, 8P, 8C, Shielded, Thru Hole, 2 Piece Structure</small>		<small>PART NO: XRJD-S-21-8-8-G</small>	
		<small>UNIT mm[inch]</small>	<small>SHEET 1 of 1</small>
		<small>REV 01</small>	<small>DATE: Mar, 24, 09</small>