

NOTES:

- MATERIALS:
 - TOP HOUSING-PBT POLYESTER UL94V-0 MIXED GLASS FIBER, BLACK COLOR.
 - BOTTOM HOUSING-DSM STANYL TE250F6 (NYLON-46) BLACK COLOR,UL94V-0
 - CONTACTS-0.35mm THICK PHOS-BRONZE C5210H PLATED 50u" NICKEL UNDERPLATE ON ALL AREA, WITH 15u" GOLD AND GOLD FLASH IN SOLDER AREA.
 - SHIELD-0.25mm THICK COPPER ALLOY, PLATED WITH NICKEL.
- OPERATING TEMPERATURE: -40°C~+85°C
- CAVITY CONFORMS TO FCC RULES AND REGULATIONS PART 68,SUBPART F.
- UNSPECIFIED TOLERANCE: .XX ±0.25
.X ±0.30

XRJD-1S-21-8-8-X-9B1

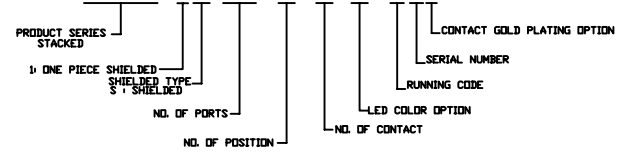

RoHS Compliant

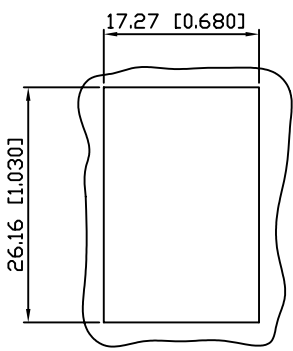
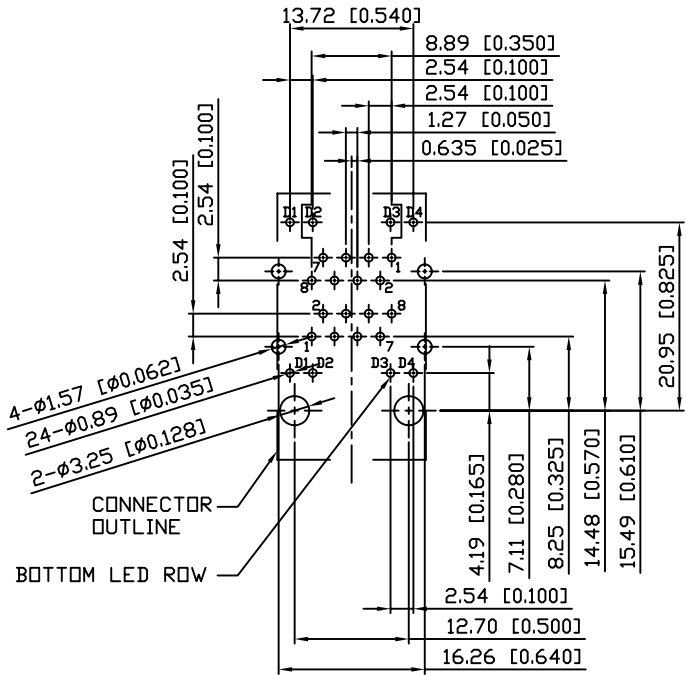

RECOMMENDED PANEL CUTOUT DIMENSION

SUGGESTED PCB LAYOUT
TOP VIEW
DIMENSIONAL TOLERANCE: .XX ±0.08 [0.003]

X MULTIPLE			THE INFORMATION AGE	
XMULTIPLE ASIA 4F, No. 347, Yang Guang St., Neihu Chiu, Taipei, Taiwan 11475		XMULTIPLE USA 1420 Los Angeles Ave., Suite G, Simi Valley, CA 93065		G/NO:
THIS DRAWING IS A CONTROLLED DOCUMENT.				
TITLE: Stacked RJ45 Connectors, w/LED, 8P,8C, Shielded, Thru Hole, Structure.			DWG NO: XRJD-1S-21-8-8-X-9B1	
PART NO: XRJD-1S-21-8-8-X-9B1			DRAWN: LEON	
			UNIT mm[inch]	SHEET 1 of 1
			REV 01	DATE: Aug.10,07
			CHKD: JEFF	