

NOTES:

- THIS CONNECTOR IS MCX RIGHT ANGLE PLUG FOR RG-178/U. LOW ENGAGE/DISENGAGE TYPE
- ITEMS ⑤ ⑦ ARE SHIPPED UNASSEMBLED.
- ELECTRICAL SPEC:
 - IMPEDANCE: 50 OHMS NOMINAL.
 - FREQUENCY RANGE: 0~6 GHz.
 - DIELECTRIC WITHSTANDING VOLTAGE: 1000 VRMS.
 - INSULATION RESISTANCE: 1000 MEGAOHMS MIN.
 - CONTACT RESISTANCE:
 - CENTER CONTACT: 5.0 MILLIOHMS MAX.
 - OUTER CONTACT: 1.0 MILLIOHMS MAX.
- MECHANICAL AND ENVIRONMENTAL SPEC:
 - MATING: SNAP-ON COUPLING.
 - ENGAGEMENT FORCE: 4.5 lbs (2.04kgf) MAX. DISENGAGEMENT FORCE: 1.0 lbs(0.45kgf) MIN.
 - DURABILITY: 500 CYCLES MIN.
 - TEMPERATURE RANGE: -65°C TO +165°C.
- UNSPECIFIED TOLERANCE: .XX ±0.25 [0.010]
.X ±0.30 [0.012]

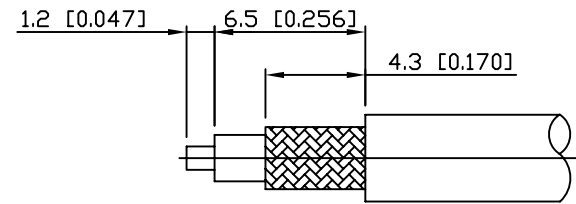
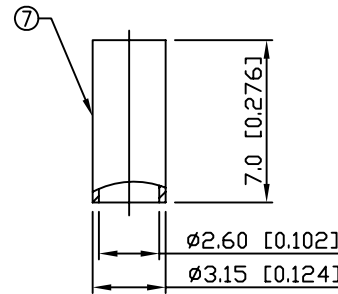

RoHS Compliant

ITEM	NAME	SPEC.	FINISH	Q'TY
7	FERRULE	BRASS	NICKEL	1
6	GUIDE PIECE	BRASS	NICKEL	1
5	COVER	BRASS	NICKEL	1
4	BODY	BRASS	NICKEL	1
3	INSULATOR	PTFE	NONE	1
2	PLUG BODY	BERYLLIUM COPPER	NICKEL	1
1	PIN CONTACT	BRASS	GOLD 0.13 um MIN OVER NICKEL	1

X MULTIPLE		CONNECTING THE INFORMATION AGE	
X MULTIPLE ASIA 4F, No. 347, Yang Guang St., Neihu, Taipei, Taiwan 11475		X MULTIPLE USA 1420 Los Angeles Ave., Suite G, Simi Valley, CA 93065	
THIS DRAWING IS A CONTROLLED DOCUMENT.		G/NO:	
TITLE: SPECIAL MCX RA PLUG		DWG NO: XRF-M3-3R8-BDA-K01	
PART NO: XRF-M3-3R8-BDA-K01		DRAWN: TOM	
UNIT: mm [inch]		SHEET: 1 of 1	
REV: 01		CHKD: JEFF	
DATE: Jan.25,08			