

Drawing for Package

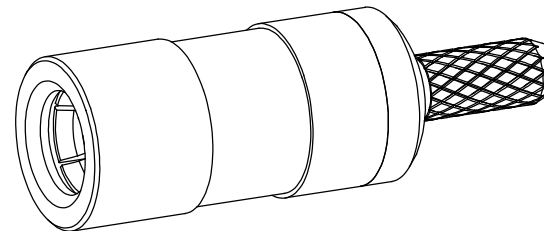
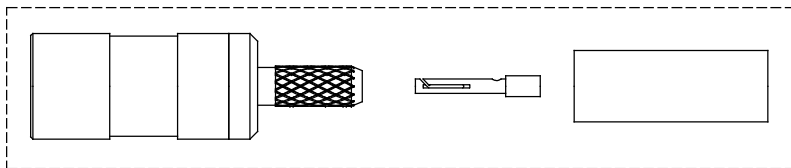

(RoHS Compliant)  
Pb ≤ 4 wt%  
Cd ≤ 75 ppm

6	FERRULE	BRASS	1	GOLD	3.2x2.3x8.7金	C2700
5	BODY	BRASS	1	GOLD	TC-2402M-1	C3604
4	CENTER PIN	BeCu	1	GOLD (3u")	TC-2402J-2-3u	C1730
3	INSULATOR	TEFLON	1	-	TC-2402J-3	ASTM D1710
2	INNER CONTACT	BeCu	1	GOLD	TC-2402J-10	C1730
7	SHELL	BRASS	1	GOLD	TC-2402J-8	C3604
NO	DESCRIPTION	MATERIAL	QTY	FINISH	ITEM #	CODE #

DIMENSIONS(mm)	TOLERANCE	DRAWING	DESCRIPTION
0-5mm	±0.05	DESIGNED	SSMB Plug Crimp for RG178/RG196
5-10mm	±0.1	CHECKER	
10-15mm	±0.2	APPROVED	
15-20mm	±0.3	UNIT: M/M	
20mm ABOVE	±0.4	SCALE 8:1	
		DATE	2013.08.01

PRODUCT NUMBER	VERSION
XRF-2402M-TBGG/1/	A00
<b>Xmultiple Technologies, Inc.</b> ISO 9001-2008	