

# Mechanical :

REV.	ECN NO.	DESCRIPTION	DATE	APPD
A	REL		28/01/2010	

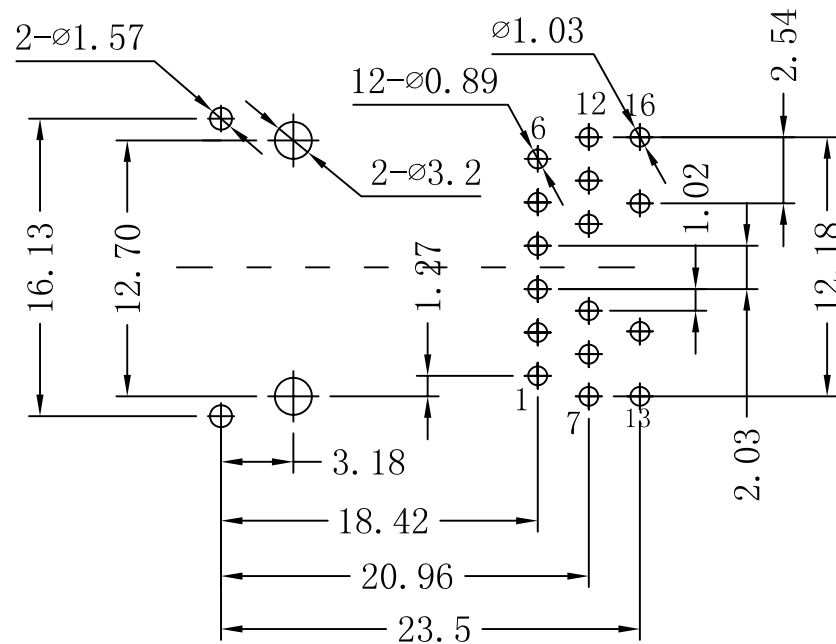
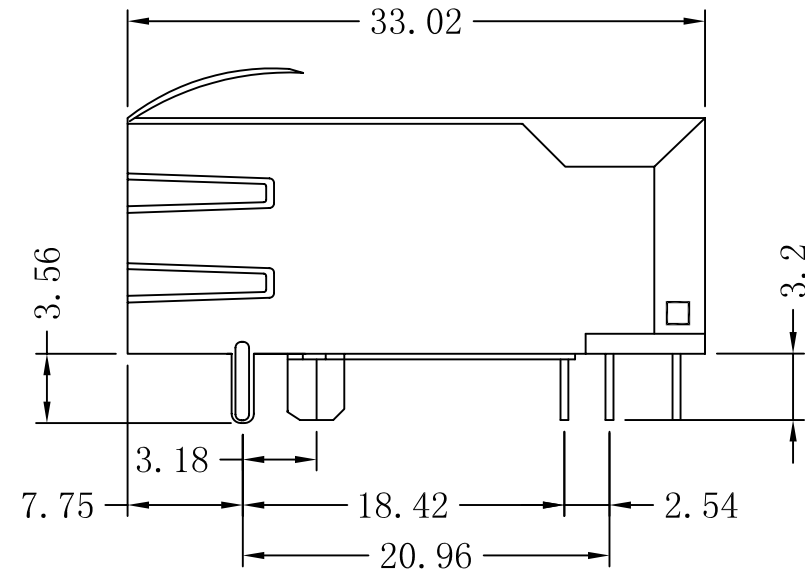
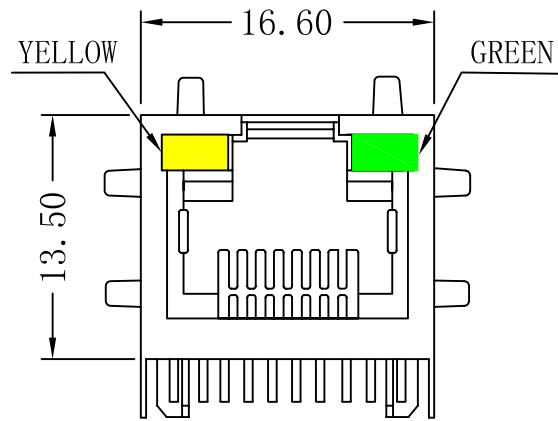

SUGGESTED PCB LAYOUT

## NOTES:

1. Designed to support application, such as SOHO (ADSL modems), LAN-on-Motherboard (LOM), hub and Switches.
2. Meets IEEE 802.3 specification
3. Connector Materials:  
Housing: Thermoplastic UL94V-0  
Contact/Shield: Copper alloy  
Shield plating: Nickel  
Contact plating: Gold 6 micro-inches min. In contact area.
4. Wave solder tip temperature: 265°C Max  
Wave solder tip temperature time: 5 Sec Max
5. UL Certification: File Number E321120



X:X	±0.20	APPD:	X MULTIPLE
X:XX	±0.10	CHKD:	
X:XXX	±0.05	DR: C. H. Y	TITLE: RJ45 Connector with 10/100 Base-TX Integrated Magnetic
ANGLES	±1°	UNIT: mm	PART NO.: XMP-TRJK0010AGNL
	SCALE: 2/1	SHEET: 1/2	REV: A
			DWG NO.: TRC10012802

# Schematic:

REV.	ECN NO.	DESCRIPTION	DATE	APPD
A	REL		28/01/2010	

PCB CONNECTIONS TO PHY

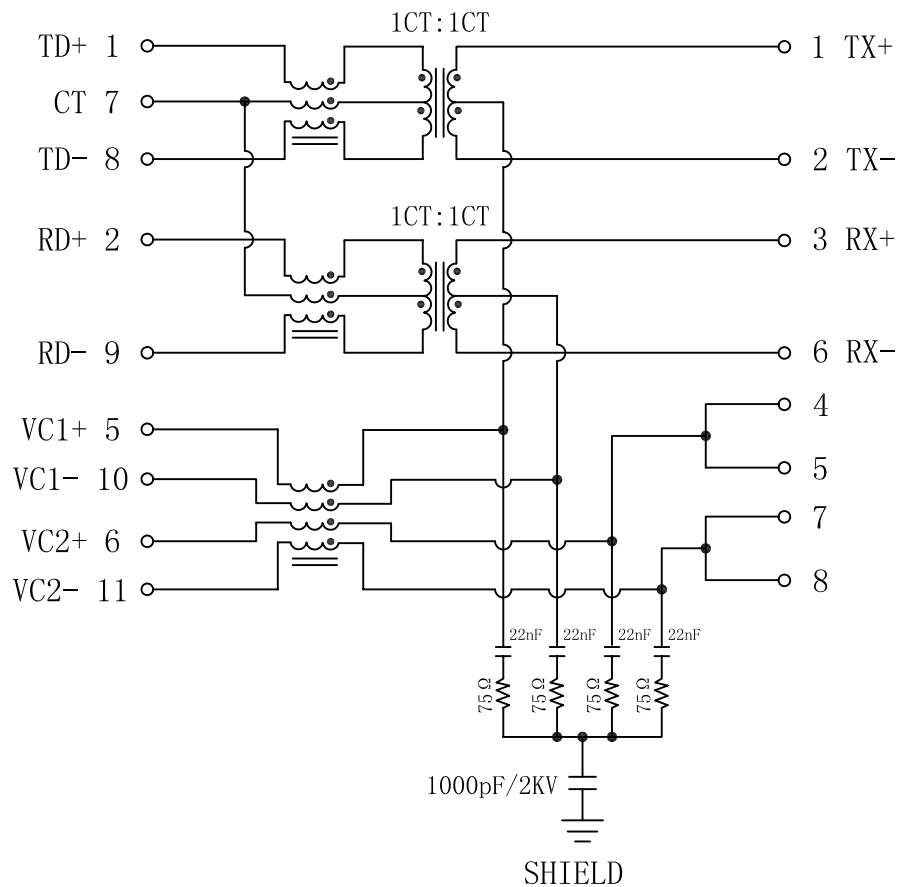

CABLE SIDE

### Electrical Specifications @25°C

- 350uH min OCL with 8mA bias current.
- Turns Ratio ( $\pm 3\%$ ):  
TX=1CT:1CT      RX=1CT:1CT
- Insertion Loss:  
1-100MHz: -1.0dB MAX
- Return Loss (dB MIN):  
1-10MHz: -20  
30MHz: -16  
60-90MHz: -12
- Crosstalk (dB MIN):  
1-10MHz: -40  
30-60MHz: -35  
60-100MHz: -30
- CMR (dB MIN):  
1-50MHz: -26  
50-130MHz: -20
- HI-POT: 1500Vrms MIN
- Operating Temperature: 0°C ~ +70°C.



YELLOW/LEFT LED

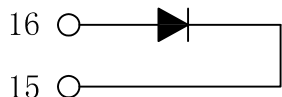

GREEN/RIGHT LED

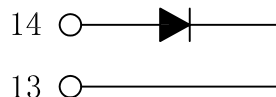

X:X	$\pm 0.20$	APPD:	<b>X</b> MULTIPLE
X:XX	$\pm 0.10$	CHKD:	
X:XXX	$\pm 0.05$	DR: C.H.Y	TITLE: RJ45 Connector with 10/100 Base-TX Integrated Magnetic
ANGLES	$\pm 1^\circ$	UNIT: mm	PART NO.: XMP-TRJK0010AGNL
	SCALE: 2/1	SHEET: 2/2	REV: A      DWG NO.: TRC10012802