

SINGLE RJ45 CONNECTOR MODULE WITH 10/100/1000 BASE-TX MAGNETICS

XMP-01J-1-P12-C01

Page : 1/4

Feature

- Meets IEEE 802.3 specification.
- High performance for maximum EMI suppression.
- LAN interface suitable for 1000 Base-TX applications.
- RoHS compliant.
- Recommended panel

Part Number	13,14 (Right Led)	15,16 (Left Led)
1	Green	Yellow

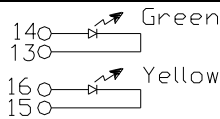

Electrical Specifications @ 25°C

Part Number	Turns Ratio (±5%)	OCL (µH Min) @ 100KHz/0.1V with 8mA DC Bias	Insertion Loss (dB Max)	Return Loss 100Ω±5Ω (dB Typ)				
				0.3-100MHz	30MHz	40MHz	50MHz	60MHz
XMP-01J-1-P12-C01	1CT : 1CT	350	-1.15	-16	-14	-13.5	-13	-10

Electrical Specifications @ 25°C

Part Number	Crosstalk (dB Typ)			Common Mode Rejection (dB Typ)			HI-POT (Vrms)
	0.3-30M Hz	30-60MHz	60-100MHz	1-30MHz	30-60MHz	60-125MHz	@60MHz/1Min
XMP-01J-1-P12-C01	-40	-35	-30	-30	-25	-20	1500

RJ45 Durability Testing Rating & Material Specification

Part Number	Durability	Mating Force	Shield	
			Material	Finish
XMP-01J-1-P12-C01	750 Insertions	5 lbs./2.268 kgs.	Brass	10-20m inches Nickel over

RJ45 Material Specification

Part Number	Contact		Housing	
	Material	Plating Area	Material	Specification
XMP-01J-1-P12-C01	Phosphor Brass	10-20m inches Nickel over selective gold plating 6µ inches	Thermoplastic	UL 94 V-0

* Operating temperature range: 0°C to +70°C. Storage temperature range: -25°C to +125°C.

SINGLE RJ45 CONNECTOR MODULE WITH 10/100/1000 BASE-TX MAGNETICS

XMP-01J-1-P12-C01

Page : 2/4

Schematic

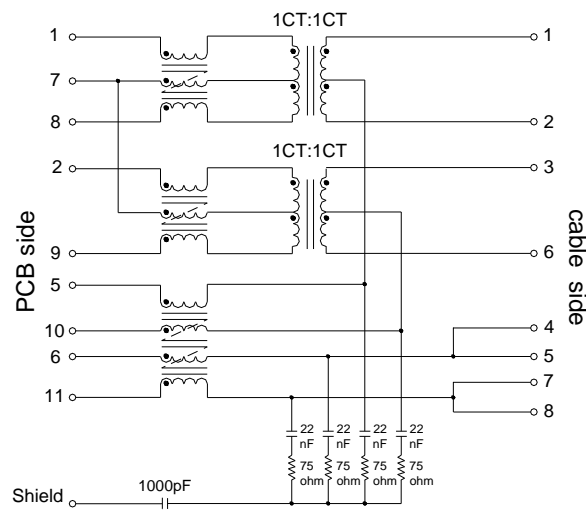

Mechanical

SINGLE RJ45 CONNECTOR MODULE WITH 10/100/1000 BASE-TX MAGNETICS

XMP-01J-1-P12-C01

Page : 3/4

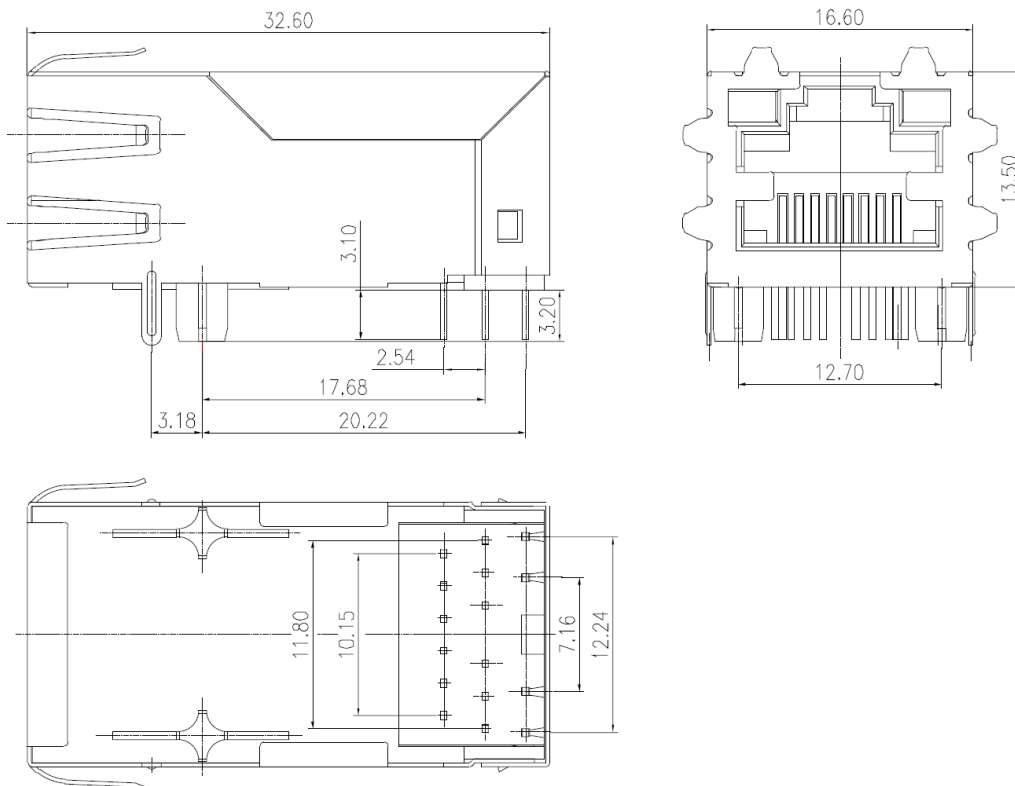

Units: mm.

Tolerance: ± 0.25 unless specified.

PCB Layout Mounting Hole (Top View)

**SINGLE RJ45 CONNECTOR MODULE WITH 10/100/1000 BASE-TX
MAGNETICS**

XMP-01J-1-P12-C01

Page : 4/4

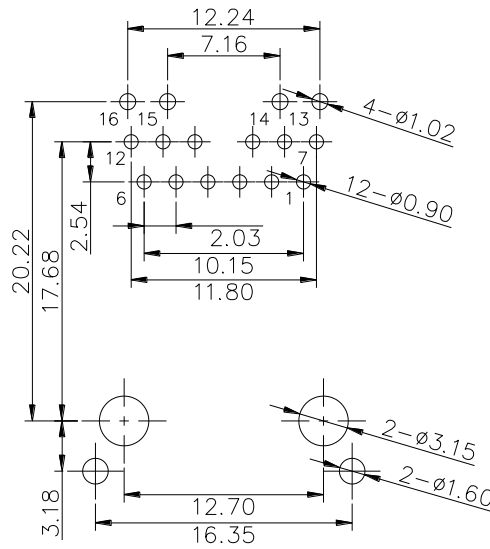

NOTE:

	XMP-J1BM11ZLAD