

# RoHS Compliance

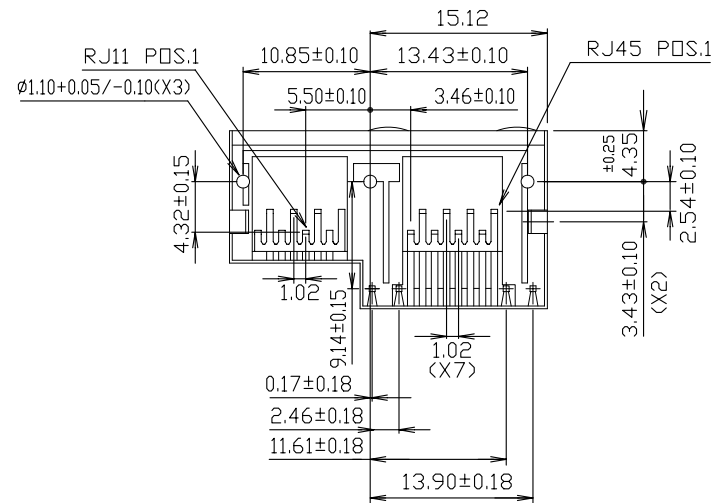

- MATERIALS:
- HOUSING-DSM STANYL TE250F6 (NYLON-46)  
HEAT DEFLECTION TEMP.290°  
BLACK COLOR,UL94V-0
  - CONTACTS-0.35mm THICK PHOS-BRONZE PLATED  
WITH 50μ" HARD GOLD AND GOLD FLASH ON  
SOLDER AREA.
  - SHIELD-0.25mm THICK COPPER ALLOY,  
PLATED WITH NICKEL.

CAVITY CONFIRMS TO FCC RULES AND REGULATIONS  
PART 68,SUBPART F.

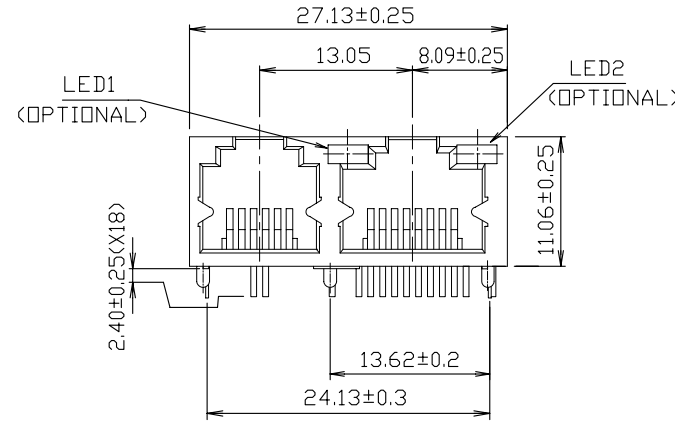
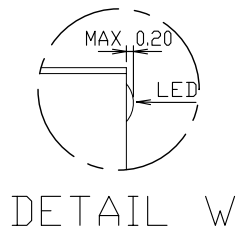
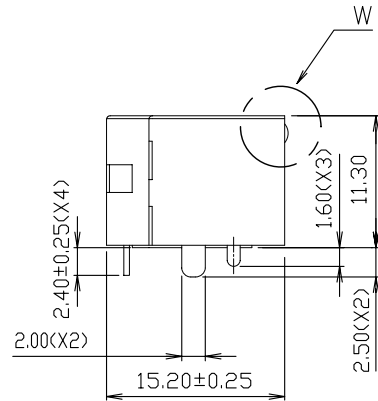
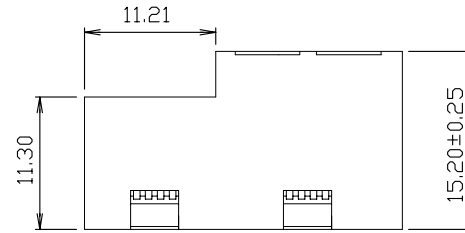
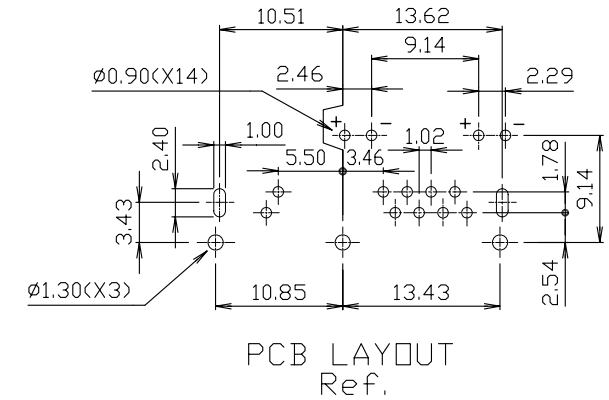

DO NOT SCALE DRAWING	TOLERANCES UNLESS OTHERWISE NOTED	INCH	MM	DR. <i>M.L.HUANG</i>	DATE OCT-13 '10	<b>XMULTIPLE</b>
THIRD ANGLE PROJECTION	LINEAR $\frac{MM}{INCH}$	00 ± .01 000 ± .005 0000 ± .002	0.0 ± 0.30 0.00 ± 0.20 0.000 ± 0.05	CK'D <i>M.CHANG</i>	OCT-13 '10	
MM INCH	ANGLE ± 0° 30'	RADII	+ 0.40 - 0.15	APP'D <i>W.J.YANG</i>	OCT-13 '10	SCALE SIZE DWG.NO. XRJC-9621-8213-2-S0LX-LFG