

RECOMMENDED P.C.B LAYOUT
TOP VIEW ±0.05

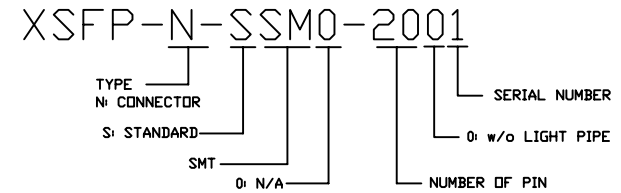
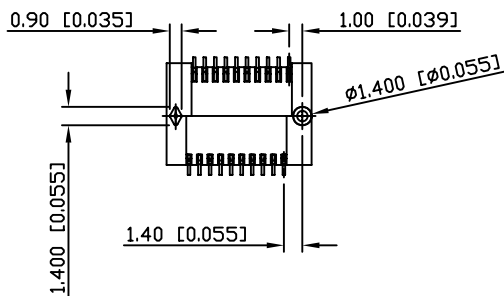
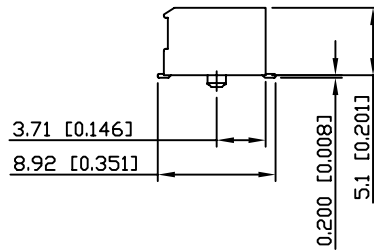
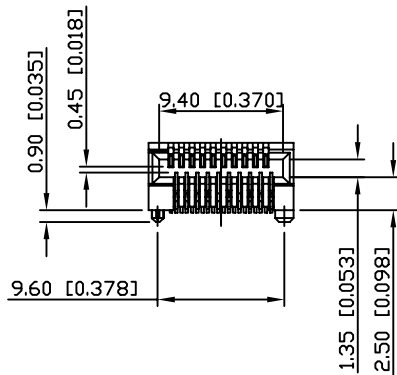

NOTE:

- MATERIAL
INSULATOR: GLASS REINFORCED THERMOPLASTIC, UL94V-0, BLACK
CONTACTS: PHOSPHOR BRONZE
- PLATING:
CONTACT AREA: 30u" GOLD PLATING
SOLDER TAILS: 3u" GOLD FLASH OVER 50u" NICKEL PLATE
- ELECTRICAL:
VOLTAGE RATING: 120VAC MAX
CURRENT RATING: 0.5 AMP
CONTACT RESISTANCE: 35 MILLIOHMS MAX
INSULATION RESISTANCE: 500 MOHMS MIN
DIELECTRIC WITHSTANDING VOLTAGE: 300VAC/MINIMUM
- ENVIRONMENTAL:
OPERATING TEMPERATURE: -55° TO +85°
- PACKING: 500PCS/REEL, 2500PCS/CARTON
- UNSPECIFIED TOLERANCE: .XXX ±0.10[0.004]
.XX ±0.20[0.008]
.X ±0.30[0.012]

RoHS Compliant

		CONNECTING THE INFORMATION AGE	
X MULTIPLE ASIA 4F, No. 347, Yang Guang St., Neihu, Taipei, Taiwan 11475		X MULTIPLE USA 1420 Los Angeles Ave., Suite G, Simi Valley, CA 93065	
THIS DRAWING IS A CONTROLLED DOCUMENT.			
TITLE: SMT CONNECTOR 0.80 MM CENTER 20 POSITIONS		DWG NO: XSFP-N-SSM0-2001	
PART NO: XSFP-N-SSM0-2001		DRAWN: TOM	
		CHKD: TARA	
UNIT: mm[inch]		SHEET: 1 of 1	
DATE: Dec.15,08		REV: 01	