

1 2 3 4 5 6 7 8

A

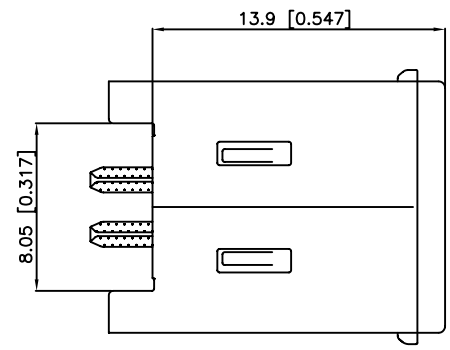
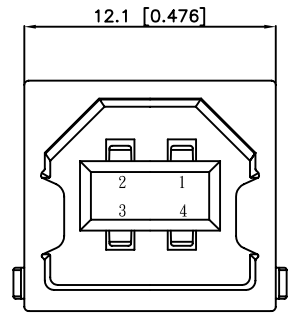
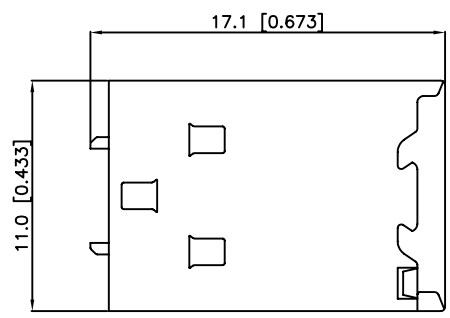
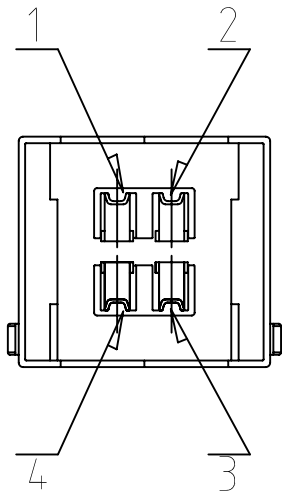
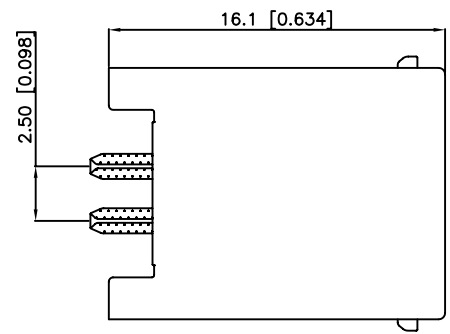

1 2 3 4 5 6 7 8

NOTES:

1. ELECTRICAL CHARACTERISTICS
 CONTACT CURRENT RATING:1.5AMPERES.
 DIELECTRIC WITHSTANDING VOLTAGE:AC 500V AT SEA LEVEL.
 INSULATION RESISTANCE:1000MEGOHMS MIN.
 CONTACT RESISTANCE:30MILLIOHMS MAX.
 OPERATING TEMPERATURE:-55°C TO +85°C
2. MECHANICAL CHARCTERISTICS
 MATING FORCE:3.5KG.MAXIMUM.
 UNMATING FORCE:1KG.MINIMUM.
3. MATERIAL
 CONTACTS : COPPER ALLOY, PLATING GOLD FLASH.
 INSULATOR : PBT. BLACK
 SHELL : COPPER ALLOY, PLATING Ni.
4. UNSPECIFIED TOLERANCE: .XX ±0.25[0.010]
 .X ±0.30[0.012]

XUSB-6-4-4-3-1-1-01

6 : USB
 4 : B/T SOLDER TYPE
 NUMBER OF PIN
 SHELL PLATING
 3 : ALL Ni

1 : BLACK
 HOUSING COLOR
 PIN PLATING
 1 : GOLD FLASH

SERIAL NUMBER

RoHS Compliant

XMULTIPLE		THE INFORMATION AGE	
XMULTIPLE ASIA 4F, No. 347, Yang Guang St., Neihu Chiu, Taipei, Taiwan 11475		XMULTIPLE USA 1420 Los Angeles Ave., Suite G, Simi Valley, CA 93065	
THIS DRAWING IS A CONTROLLED DOCUMENT.		G/NO:	
TITLE: USB B TYPE, SOLDER TYPE		DWG NO: XUSB-6-4-4-3-1-1-01	
PART NO: XUSB-6-4-4-3-1-1-01		DRAWN: AUSTIN	
		CHKD: JEFF	
UNIT mm[inch]		SHEET 1 of 1	
REV 01		DATE: Jan.02,07	

A

B

C

D

E

F