

REVISIONS					
ECO	ZONE	REV	DESCRIPTION	DATE	APPROVED
		J1	REVISED RELEASE	07/31/01	Chen

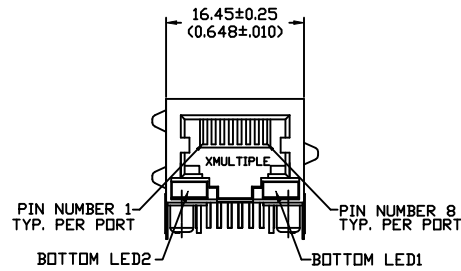

FRONT VIEW

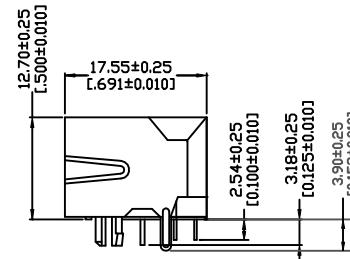

SIDE VIEW

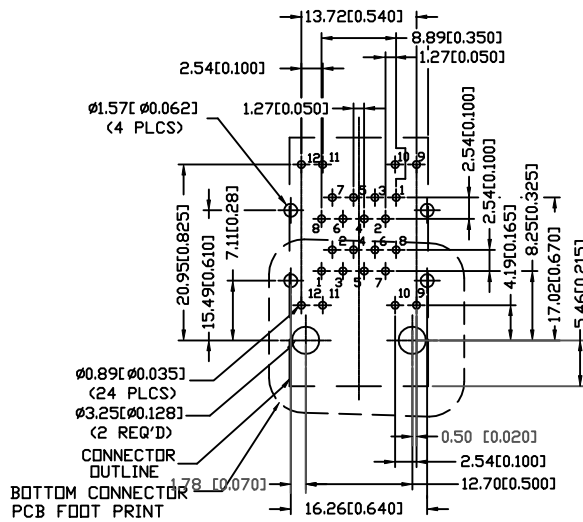

SUGGESTED PCB LAYOUT
(COMPONENT SIDE)

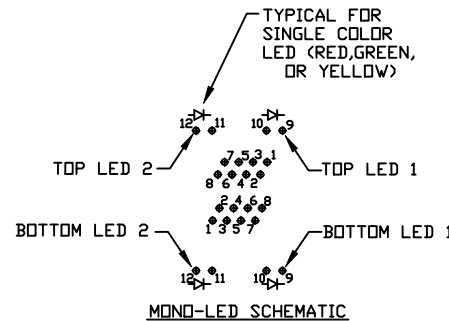
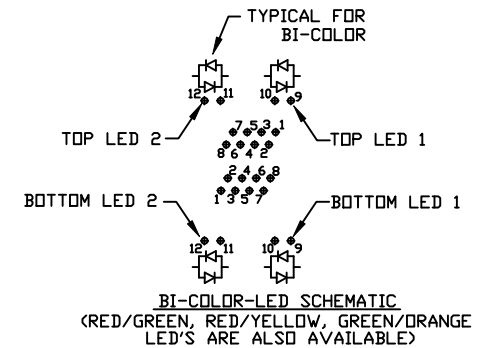

1. MATERIALS:
 HOUSING HIGH TEMP. THERMOPLASTIC, BLACK, UL 94V-0
 CONTACTS: 0.014 INCHES (0.35 MILLIMETERS) THICK PHOSPHOR BRONZE PLATED WITH 150 MICROINCHES (3.81 MICROMETERS) MINIMUM THICK TIN LEAD IN SOLDER AREA. 15 MICROINCHES (0.38 MICROMETERS) MINIMUM GOLD IN LOCALIZED PLATE AREA. ENTIRE CONTACTS PLATED WITH 50 MICROINCHES (1.27 MICROMETERS) MINIMUM THICK NICKEL. SHIELDED: 0.0098 INCHES (0.25 MILLIMETERS) THICK COPPER ZINC ALLOY PLATED WITH 30 MICROINCHES (0.762 MICROMETERS) MINIMUM THICK NICKEL.

2. JACK CAVITY CONFORMS TO FCC RULES AND REGULATIONS PART 68, SUBPART F

3. PART NUMBER: XRJD-S-24-8-8-X

REFER TO LED OPTIONS TABLE FOR ORDERING CODES

NOTES:
 UNLESS OTHERWISE SPECIFIED
 UNSPECIFIED TOLERANCE: .XX (±0.010) (0.25)
 .X (±0.004) (0.15)

XMULTIPLE		CONNECTING THE INFORMATION AGE
XMULTIPLE ASIA 11F-1, No. 70, Pei-Hsing N. Road Taipei, Taiwan, R.O.C.		XMULTIPLE USA 848 Conestoga Club Drive #B-128 Simi Valley, CA 90086
THIS DRAWING IS A CONTROLLED DOCUMENT.		
TITLE: Stacked RJ45, Connectors, w/LED, BP, BC, Shielded, Thru Hole, Bottom Piece		Dwg No: PDS24-XRD21 Drawn: VIQ
PART NO: XRJDB-S-01-8-8-X		Ckd: E. KOLLAR Date: 09/10/02
	DIMENSIONS [mm]inch	SHEET 1 of 1
		REV J1