

1. MECHANICAL DIMENSIONS :

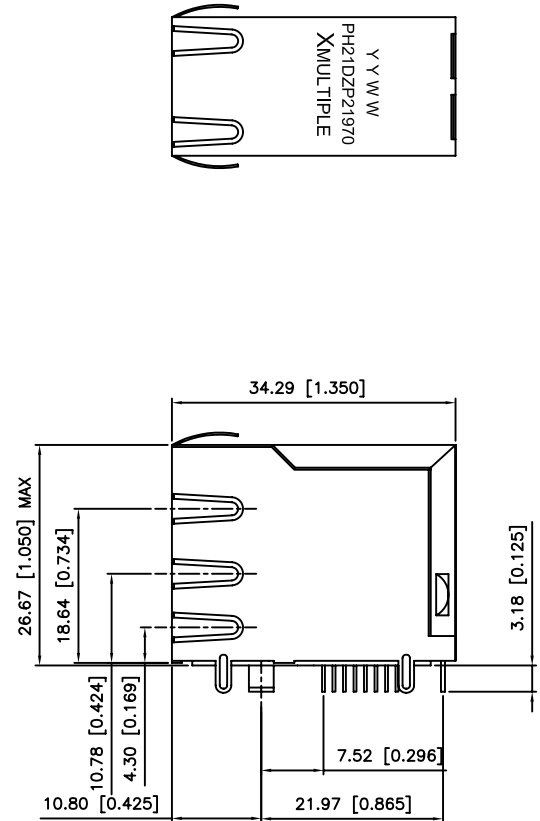

RECOMMENDED PLUG DIMENSION:

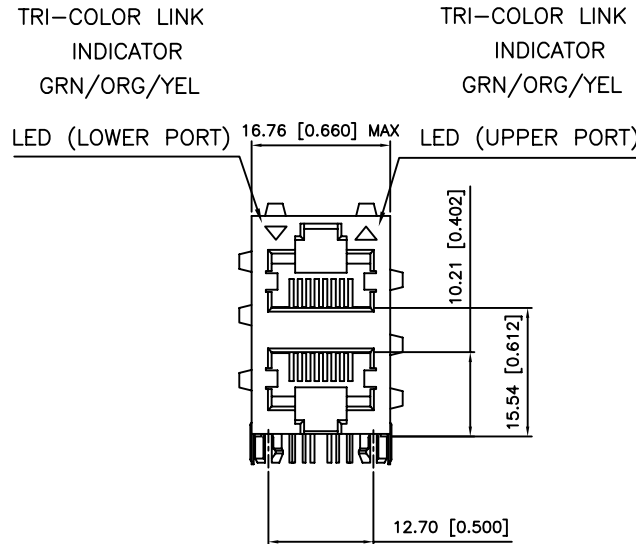
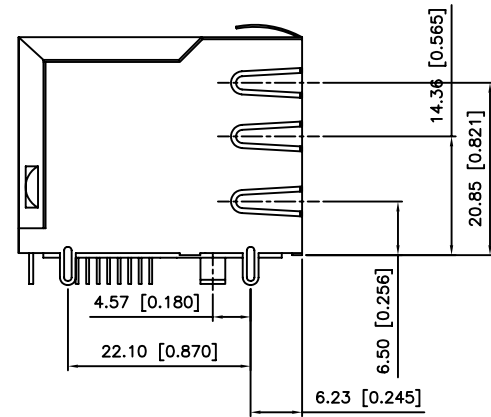
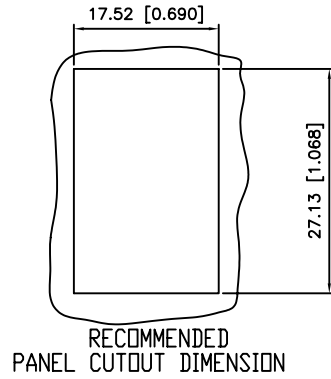
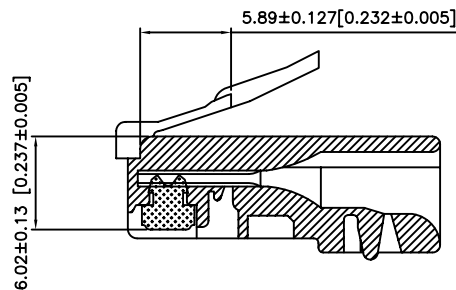

NOTES:

- MATERIAL:
HOUSING—PBT POLYESTER UL-94V-0
MIXED GLASS FIBER.
STANDARD COLOR—BLACK
CONTACTS—0.35mm THICK PHOS—BRONZE PLATED
WITH 15u" GOLD AND TIN IN
SOLDER AREA.
SHIELD—0.20mm THICK COPPER ALLOY,
PLATED WITH NICKEL.
- OPERATING TEMPERATURE: 0°C~+70°C
- CAVITY CONFORMS TO FCC RULES AND REGULATIONS
PART 68,SUBPART F.
- UNSPECIFIED TOLERANCE: .XX ±0.25[0.010]
.X ±0.30[0.012]

RoHS Compliant

		CONNECTING THE INFORMATION AGE	
XMULTIPLE ASIA 4F, No. 347, Yang Guang St., Neihu, Taipei, Taiwan 11475		XMULTIPLE USA 1420 Los Angeles Ave., Suite G, Simi Valley, CA 93065	
THIS DRAWING IS A CONTROLLED DOCUMENT.		G/NO:	
TITLE: Stacked RJ45, W/LED, with 10/100/1000 Mbps LAN Magnetics 8P,10C, Shielded, Thru Hole, For P.O.E.		DWG NO: XPJH-21D-Z-P21-970-MHF	
PART NO: XPJH-21D-Z-P21-970-MHF		DRAWN: RUNES	
		CHKD: JEFF	
UNIT mm[inch]		SHEET 1 of 3	
DATE: Mar.18,08		REV 01	

2. PCB LAYOUT :

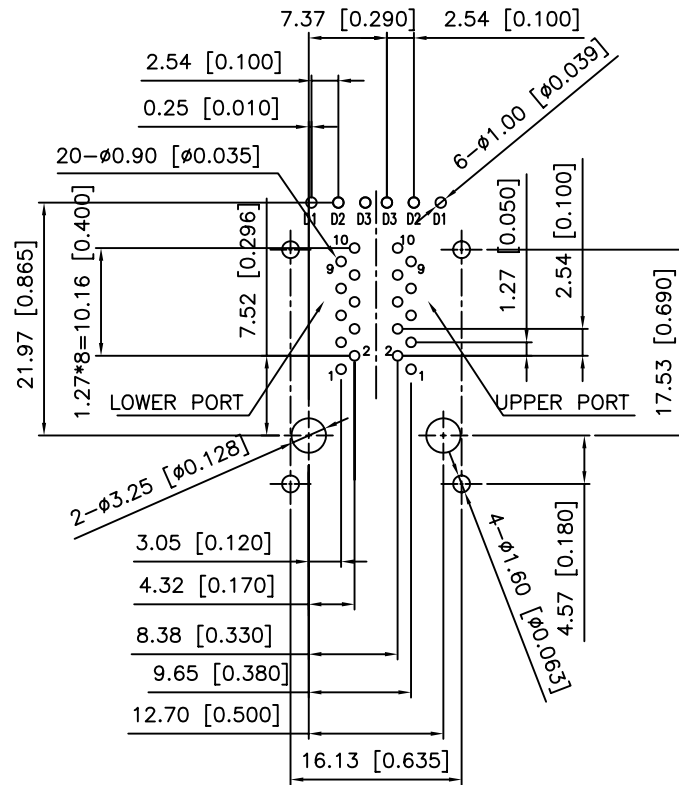

SUGGESTED PCB LAYOUT
(TOP VIEW)

DIMENSIONAL TOLERANCE: .XX ±0.08[0.003]

3. LED CONFIGURATION :

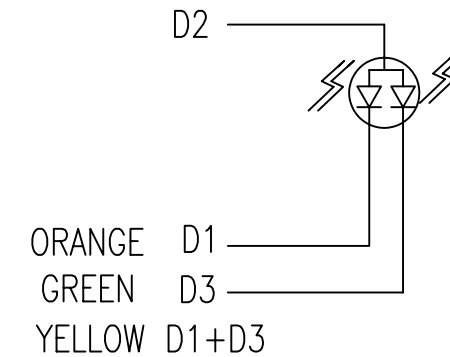

Color	Lens Color	Vf(v) @20mA		Iv(mcd) @10mA		Viewing angle 2θ 1/2	If (mA)	Peak wave Length λP(nm)
		Min	Max	Min	Typ			
Orange	White Diffused	1.7	2.6	1.8	4.0	116	20	610
Green		1.7	2.8	3.5	6.0	116	20	568

RoHS Compliant

XMULTIPLE		CONNECTING THE INFORMATION AGE	
XMULTIPLE ASIA 4F, No. 347, Yang Guang St., Neihu, Taipei, Taiwan 11475		XMULTIPLE USA 1420 Los Angeles Ave., Suite G, Simi Valley, CA 93065	
THIS DRAWING IS A CONTROLLED DOCUMENT.			G/NO:
TITLE: Stacked RJ45, W/LED, with 10/100/1000 Mbps LAN Magnetics 8P,10C, Shielded, Thru Hole, For P.O.E.			DWG NO: XPJH-21D-Z-P21-970-MHF
PART NO: XPJH-21D-Z-P21-970-MHF			DRAWN: RUNES
UNIT SHEET REV mm[inch] 2 of 3 01			CHKD: JEFF
			DATE: Mar.18,08

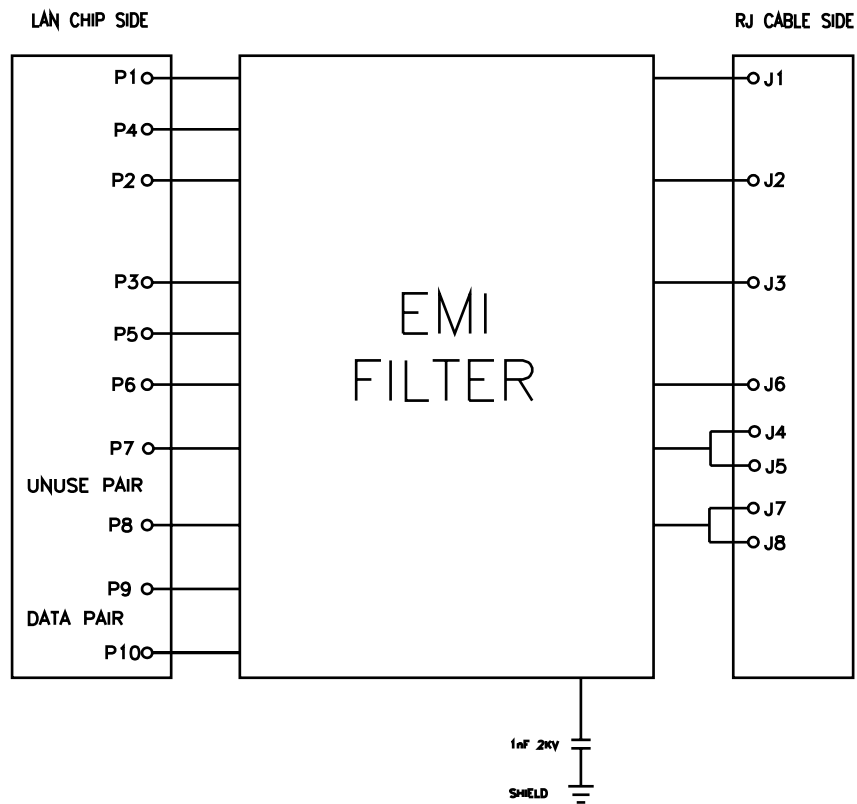

TEST NOTES:(25±5°C)

1.TR:(100KHz,0.1V);

PINS:(P1-P2):(J1-J2)=1:1±3%

PINS:(P3-P6):(J3-J6)=1:1±3%

2.LX:(100KHz,100mV,8mA, DC Bias)

PINS:(P1,P2),(P3,P6)=350uH MINIMUM

3.DCR:

PINS:(J1,J2),(J3,J6),(J4,J5),(J7,J8)=1.2 OHMS MAXIMUM

4.HIPOT:

PINS(P1,P4,P2)TO(J1,J2)=1500VAC FOR 60 SECONDS

PINS(P3,P5,P6)TO(J3,J6)=1500VAC FOR 60 SECONDS

5.INSERTION LOSS:

-1.0dB MAXIMUM AT 0.3MHz TO 100MHz;

6.RETURN LOSS:

-20dB MINIMUM AT 1MHz TO 30MHz;

-15dB MINIMUM AT 30MHz TO 60MHz

-10dB MINIMUM AT 60MHz TO 80MHz

7.CROSS TALK:

-30dB MINIMUM AT 1MHz TO 100MHz

8.COMMON TO COMMON MODE REJECTION:

-30dB MINIMUM AT 1MHz TO 100MHz

CUSTOMER CODE

X MULTIPLE

xMULTIPLE ASIA
4F, No. 347, Yang Guang St.,
Neihu, Taipei, Taiwan 11475

xMULTIPLE USA
Simi Valley, CA 93065

CONNECTING
THE INFORMATION
AGE

TITLE: Stacked RJ45, W/LED, with 10/100/1000 Mbps LAN Magnetics
8P,10C, Shielded, Thru Hole, For P.O.E.

PART NO:

UNIT SHEET

RUNES

JEFF

Mar.18,08