

1. MECHANICAL DIMENSIONS :

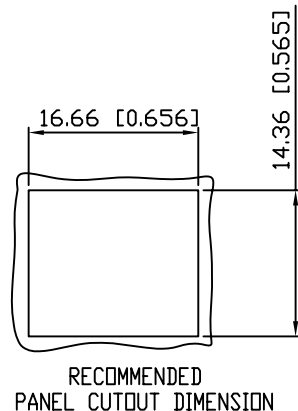

NOTES:

- MATERIALS:  
HOUSING-NYLON POLYESTER UL94V-0  
MIXED GLASS FIBER,  
STANDARD COLOR-BLACK.  
CONTACTS-0.35mm THICK PHOS-BRONZE PLATED  
WITH 30u" GOLD AND TIN  
IN SOLDER AREA.  
SHIELD-0.25mm THICK COPPER ALLOY,  
PLATED WITH NICKEL.
- CAVITY CONFIRMS TO FCC RULES AND REGULATIONS  
PART 68,SUBPART F.
- UNSPECIFIED TOLERANCE: .XX ±0.25[0.010]  
.X ±0.30[0.012]

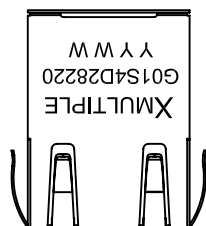
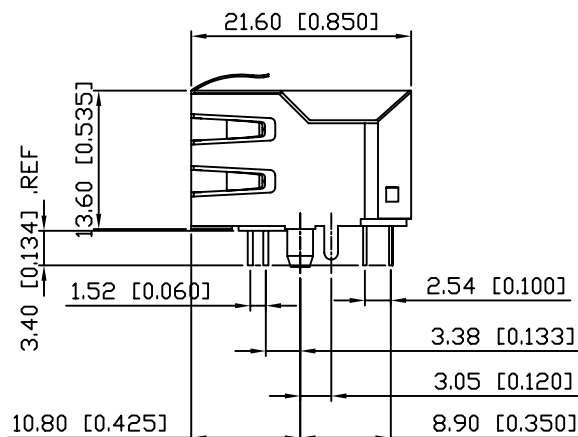
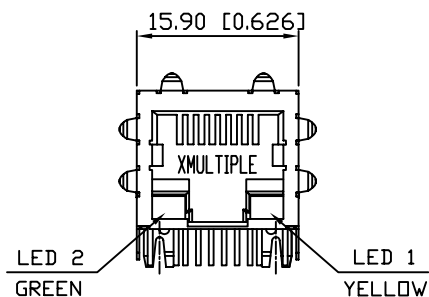

RECOMMENDED PLUG DIMENSION:

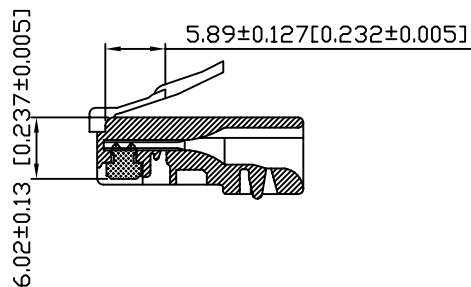

RoHS Compliant

<b>X MULTIPLE</b>		CONNECTING THE INFORMATION AGE	
MULTIPLE ASIA 4F, No. 347, Yang Guang St., Neihu Chu, Taipei, Taiwan 11475		MULTIPLE USA 1420 Los Angeles Ave., Suite G, Simi Valley, CA 93065	
THIS DRAWING IS A CONTROLLED DOCUMENT.		DWG NO: XRJG-01S-4-D28-220	
TITLE: RJ45, Connectors, w/LED, 8P, 8C, Shielded Thru Hole/10/100 Mbps FILTER		DRAWN: RUNES	
PART NO: XRJG-01S-4-D28-220		CHKD: JEFF	
	UNIT	SHEET	REV
	mm[inch ]	1 of 3	01
		DATE: Apr.19,06	

2. PCB LAYOUT :

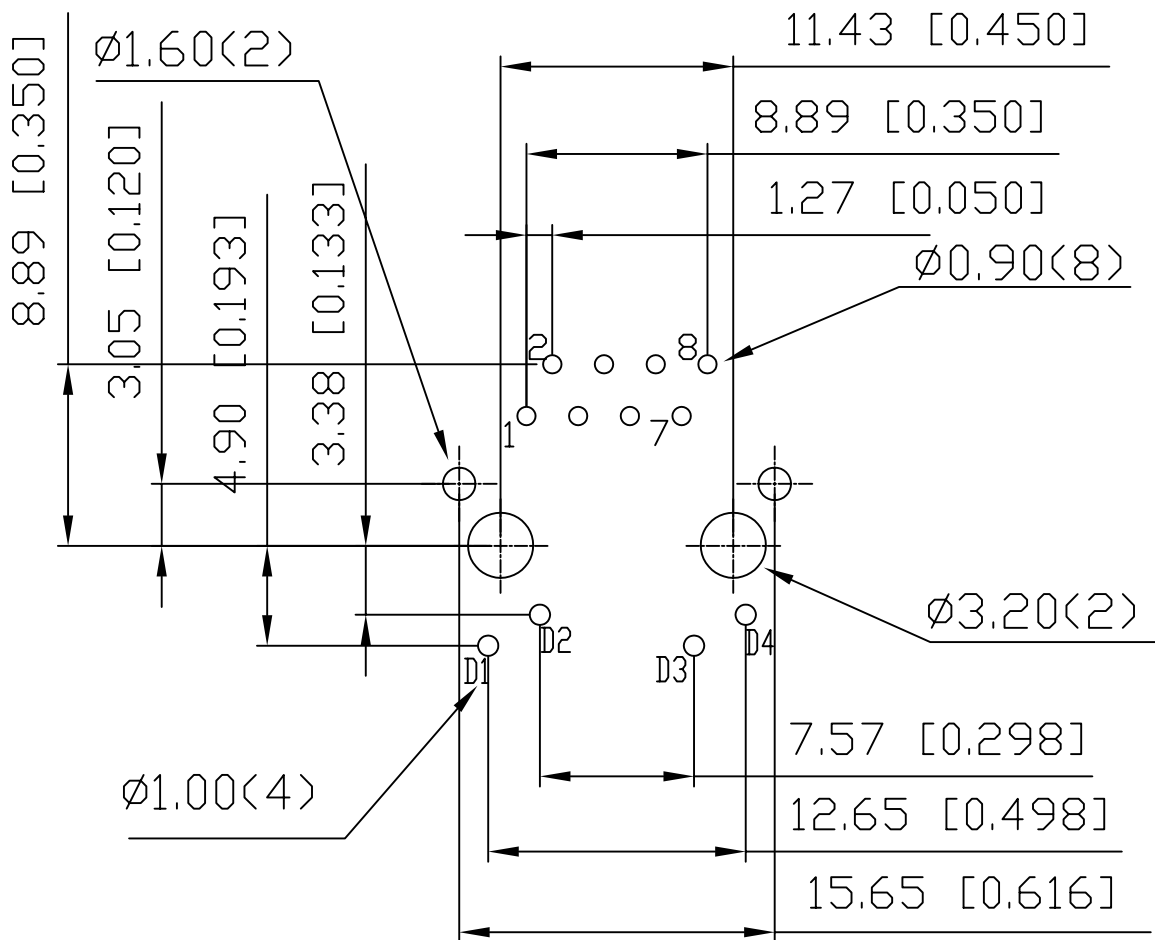

SUGGESTED PCB LAYOUT  
(TOP VIEW)

3. LED CONFIGURATION

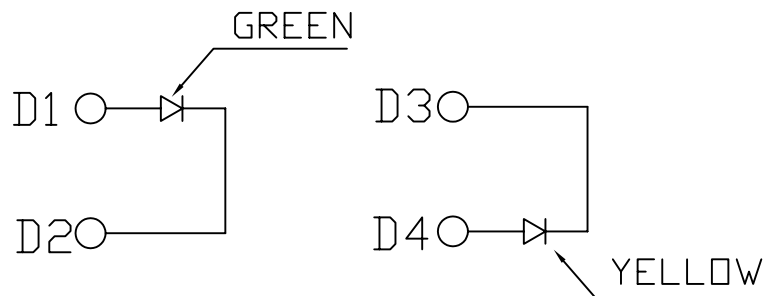

Color	Lens Color	Vf(v) @20mA		Iv(mcd) @10mA		Viewing angle 2θ 1/2
		Min	Max	Min	Typ	
Yellow	Yellow Diffused	1.7	2.8	3.0	6.0	116
Green	Green Diffused	1.7	2.8	3.5	6.0	116

RoHS Compliant

		CONNECTING THE INFORMATION AGE	
X MULTIPLE ASIA 4F, No. 347, Yang Guang St., Neihu Chu, Taipei, Taiwan 11475		X MULTIPLE USA 1420 Los Angeles Ave., Suite G, Simi Valley, CA 93065	
THIS DRAWING IS A CONTROLLED DOCUMENT.			
TITLE: RJ45, Connectors, w/LED, 8P, 8C, Shielded Thru Hole/10/100 Mbps FILTER		DWG NO: XRJG-01S-4-D28-220	
PART NO: XRJG-01S-4-D28-220		DRAWN: RUNES	
		UNIT mm [inch]	SHEET 2 of 3
DATE: Apr.19,06		REV 01	CHKD: JEFF

#### 4. SCHEMATIC :

#### 5. ELECTRICAL CHARACTERISTICS :

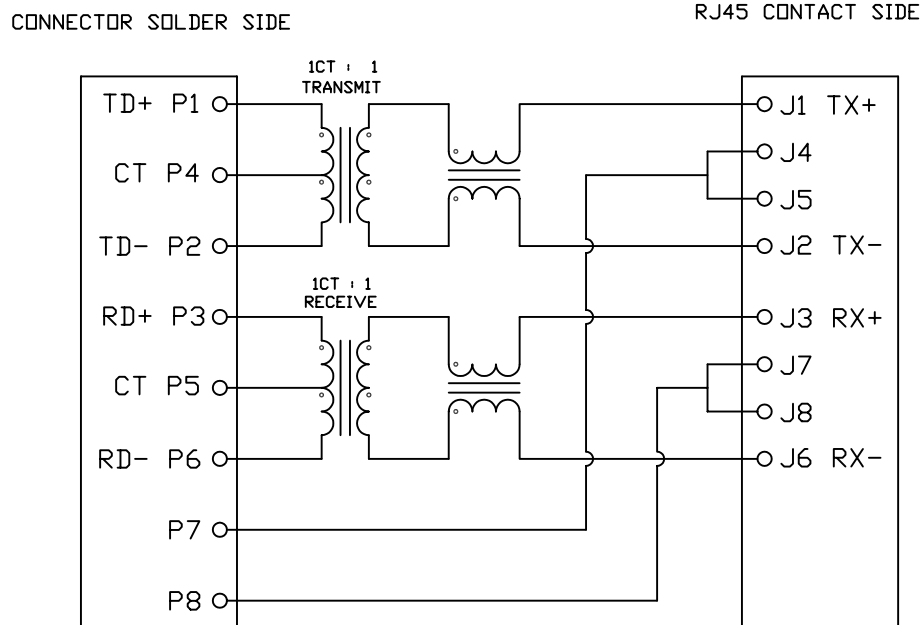

TEST NOTES:(25±5°C)

1.TR:(100KHz,0.1V);

PINS:(P1-P2):(J1-J2)=1:1±3%

PINS:(P3-P6):(J3-J6)=1:1±3%

2.LX:(100KHz,100mV,8mA, DC Bias)

PINS: (P1,P2),(P3,P6)=350uH MINIMUM

3.DCR:

PINS:(P1-P2),(J1-J2),(J3-J6)= 1.0 OHMS MAXIMUM

PINS:(P3-P6)=1.2 OHMS MAXIMUM

4.HIPOT:

PINS(P1,P4,P2)TO(J1,J2)=1500VAC FOR 60 SECONDS

PINS(P3,P5,P6)TO(J3,J6)=1500VAC FOR 60 SECONDS

5.INSERTION LOSS:

-1.0dB MAXIMUM AT 0.3MHZ TO 100MHZ;

6.RETURN LOSS:

-20dB MINIMUM AT 1MHZ TO 30MHZ;

-15dB MINIMUM AT 30MHZ TO 60MHZ

-10dB MINIMUM AT 60MHZ TO 80MHZ

7.CROSS TALK:

-30dB MINIMUM AT 1MHZ TO 100MHZ

8.COMMON TO COMMON MODE REJECTION:

-30dB MINIMUM AT 1MHZ TO 100MHZ

**XRJG-01S-4-D28-220**

PRODUCT SERIES  
G : TAB DOWN WITH LED

NUMBER OF PORT  
MECHANICAL TYPE  
01S : XRJG 1 PORT,  
OBLIQUE LED PIN

LED COLOR OPTION

PROTOCOL TYPE  
D : 10/100 Mbps, 4 CORE

SPECIAL CODE  
0 : STANDARD

SHIELDED TYPE  
2 : Y=3.05mm, NON-EMI FINGER

LED POLARITY  
2 : +-, -+

CIRCUIT TYPE

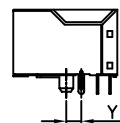

# RoHS Compliant

<b>X</b> MULTIPLE		CONNECTING THE INFORMATION AGE	
MULTIPLE ASIA 4F, No. 347, Yang Guang St., Neihu Chu, Taipei, Taiwan 11475		MULTIPLE USA 1420 Los Angeles Ave., Suite G, Simi Valley, CA 93065	
THIS DRAWING IS A CONTROLLED DOCUMENT.			
TITLE: RJ45, Connectors, w/LED, 8P, 8C, Shielded Thru Hole/10/100 Mbps FILTER		DWG NO: XRJG-01S-4-D28-220	
PART NO: XRJG-01S-4-D28-220		DRAWN: RUNES	
UNIT: mm [inch]		SHEET: 3 of 3	
REV: 01		DATE: Apr.19,06	
CHKD: JEFF			